



britax
römer

SWIVEL-GROW MAX Air
USER GUIDE

BRITAX CHILD SAFETY

www.britax.com | contact@britax.com

Contents

1. Important Notice	04
1-1 User Guide	04
1-2 Intended use	04
1-3 Misuse	05
1-4 Safety informations	06
2. Installation	10
2-1 Fastening types	10
2-2 Secure child seat A (40 – 105cm)	12
2-3 Secure child seat B (100 – 125 cm)	18
3. Buckling in and unbuckling	24
3-1 Buckle child in A (40 – 105cm)	24
3-2 Check before every journey A (40 – 105cm)	25
3-3 Unbuckle child A (40 – 105cm)	28
4. Use the insert for newborn babies	29
5. Buckle child in B (100 – 125 cm)	30
5-1 Check before every journey B (100 – 125 cm)	31
5-2 Unbuckle child B (100 – 125 cm)	32

6. Changing the fastening type	33
6-1 Changing to fastening type B (100 – 125 cm)	33
6-2 Changing to fastening type A (40 – 105cm)	37
7. Adjust the Seat	40
7-1 Adjusting the seat angle	41
7-2 Change direction of travel	42
7-3 Boarding and exit function	44
7-4 Tighten adjustment strap	46
7-5 Adjust headrest	47
8. Cleaning and maintenance	49
8-1 Cover	49
8-2 Shoulder pads	51
8-3 Troubleshooting	53
9. Storage and disposal	54
10. Installing and Removing Canopy	55
11. Fan Operation instruction	56
12. Warning Notice	58
13. Contact	59

1 Important Notice

1.1 User Guide



This user guide is a component of the product and contributes to its safe use. Non-compliance may lead to serious or even fatal injuries. If there are uncertainties, do not use the product and immediately contact your retailer.

- ▶ Read the operating instructions.

1.2 Intended use

This product has been designed, tested and approved corresponding to the requirements of GB27887 - 2024. It is designed for securing a child in a vehicle.

This child seat is approved for children with a height from 40 cm to 125 cm. So that the child is optimally secured, there are two types of fastening, A and B. Each fastening type has been developed for a defined size range. Secure the child seat corresponding to the size of the child.

Size of the child	Fastening type
40 cm - 105 cm	A
 Maximum weight 18 kg.	
 You must use the insert for newborn babies for body sizes up to 75 cm.	
100 cm - 125 cm	B

Use the product on forward-facing car seats. This approval is invalidated if you make any modifications to this product. Changes may only be made by the manufacturer.

The stickers on the product are an important component of the product.

- ▶ Do not make any changes to the product.
- ▶ Do not remove any stickers from the product.

1.3 Misuse

- ▶ Do not use the product as a toy.
- ▶ Do not use the product as a chair outside the vehicle.
- ▶ Only secure the child seat with fastening points described in these operating instructions.
- ▶ Never secure the product with a 2-point seat belt.
- ▶ Ensure that the product is not trapped between hard objects (car door, seat rails, etc.).
- ▶ Keep product away from moisture, wet conditions, liquids, dust and salt spray.
- ▶ Do not lean heavy objects on the product.
- ▶ Never lubricate or oil parts of the product.
- ▶ Sensitive car seat covers may be damaged. Use the Britax child seat base. These are available separately.

1.4 Safety informations

Risk of injury from damaged child seat

In the event of an accident at a collision speed of more than 10 km/h, the child seat may be damaged without the damage being immediately visible. Serious injuries may result from another accident.

- ▶ Replace the product after an accident.
- ▶ Have a damaged product inspected (even if it has fallen onto the ground).
- ▶ Regularly check all the important parts for damage.
- ▶ Ensure that all mechanical components work properly.

Risk of burns from hot components

Components of the product may become hot in direct sunlight. Children's skin is sensitive and maybe harmed as a result.

- ▶ Protect the product against intensive direct sunlight when not in use.

Risk of injury during use

The temperature in a vehicle can rise dangerously quickly.

In addition, it is dangerous to leave the vehicle on the side facing the street.

- ▶ Never leave the child unsupervised in the vehicle.
- ▶ Only secure and remove the child seat from the footpath-side.

Risk of injury from unsecured objects

In case of an emergency stop or accident, unsecured objects or people may cause injury to other occupants in the vehicle.

- ▶ Only fasten the product as described in this user guide.
- ▶ Secure backrests of the car seat (e.g. engage foldable rear).
- ▶ Fasten or remove all heavy or sharp-edged objects in the vehicle (e.g. on the parcel shelf).
- ▶ Ensure that everyone in the vehicle has their seatbelts fastened.
- ▶ Ensure that the product is always secured when it is in the vehicle, even if no child is being transported.
- ▶ This child car seat is suitable for child's whose stature is 40-105cm/≤18kg i-Size universal ISOFIX 100-125cm i-Size booster seat.
- ▶ Please find user manual from the User manual pocket, and read carefully.
- ▶ Please read the instruction manual carefully before installation. Serious injury may occur if installed incorrectly. The manufacturer will not take responsibility for any risks in this case.
- ▶ Never use the child car seat without textile cover. Never use any cover which is not recommended by manufacturer to replace an old cover, because the cover constitutes an integral part of the child car seat performance.
- ▶ When the child car seat is not provided with a textile cover, the child car seat should be kept away from direct sunlight, otherwise it may be too hot for child's skin.
- ▶ The customer is advised not to use the child car seat in seating positions where there is an active frontal airbag installed.
- ▶ The child car seat should be replaced when it has been subject to violent stresses in an

accident.

- ▶ Please ensure all passengers in the vehicle use safety belt, goods in vehicle must be fixed down, otherwise the passengers and goods may injure child in the event of an emergency.
- ▶ The buckle should not be in a semi-locked status. Always confirm the child car seat is locked before using. So that in an emergency the child can be taken out quickly.
- ▶ Don't make any changes to the harness system in the child car seat ,this could seriously affect the security and functionality.
- ▶ It is dangerous to make any alterations or additions the child car seat without the approval of the Type Approval Authority. It's also dangerous to not closely follow the installation instructions provided by the child car seat manufacturer.
- ▶ Ensure that children are not left in their car seat unattended.
- ▶ Keep the child seat away from any corrosive substances.
- ▶ Always keep the child car seat secured in the vehicle even when it is unoccupied and ensure that children are not left in their child car seat unattended.
- ▶ DO NOT use a second hand child car seat.
- ▶ The importance of ensuring that any lap strap is worn low down, and that any impact shield installed properly, so that the pelvis is firmly engaged, shall be stressed.
- ▶ Any straps holding the child car seat to the vehicle should be tight,and any straps restraining the child should be adjusted to be suitable to the child's body. Ensure that the straps are not be twisted.
- ▶ Do not use any load bearing contact points other than those described in the instructions and marked in the child car seat.

- ▶ The instructions can be retained on the child car seat for its life time,ensure to take good care of the manual.
- ▶ The rigid items and plastic parts of the child car seat must be located and installed so that they are not liable,during everyday use of the vehicle,to become trapped by a movable seat or in a door of a vehicle.
- ▶ Any luggage or other objects liable to cause injuries in the event of a collision should be properly secured.
- ▶ If you have any questions about the use and installation of the child seat, please contact the manufacturer or retailer.
- ▶ Prior to installing the child car seat the user should refer to the vehicle manufacturer's handbook.
- ▶ The child restraint may not fit in all approved vehicles when used in one of these position

2 Installation

2.1 Fastening types

Fastening type A and B

This product is supplied with the configuration for fastening type A. If you want to use fastening type B, you have to change the fastening type.

2.1.1 Fastening type A (40 – 105 cm)

With fastening type A, the child seat is secured with ISOFIX **3** and the support leg **2** on the car seat. The child is secured in the child seat with the 5-point harness **1**.

In fastening type A, the seat can be turned. Use the child seat as intended with regard to age and size of the child.

Ensure that the Indicator Window **4** is set to the correct mode.



Fastening type	Design
A1	Rear-facing seat (40-105cm/≤18kg)
A2	Forward-facing seat (76-105cm/≤18kg)

2.1.2 Fastening type B (100 – 125 cm)

With fastening type **B**, the child is secured in the child seat with a 3-point seat belt **1**. Suggest to secure the child seat with ISOFIX **2** as well. Use of the support leg is not approved for fastening type **B**. Use the child seat facing forwards. Use the child seat as intended with regard to age and size of the child.

Ensure that the Indicator Window **3** is set to the correct mode.

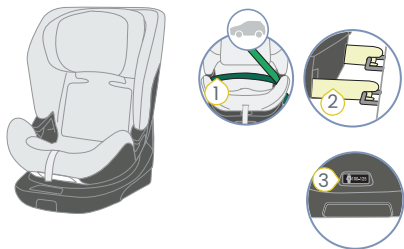

- ① 3- Point Seat Belt
- ② ISOFIX
- ③ Indicator Window



Fastening type	Design
B	3-point seat belt and ISOFIX(optional)

2.2 Secure child seat A (40 – 105cm)

2.2.1 Select seat

1. Note and observe the vehicle handbook.

NOTE: Only car seats arranged in the direction of travel are approved for use.

2. Select a suitable seat.

- Car seats with i-Size approval are suitable.

NOTE: In rare cases, the child seat on car seats with i-Size approval can only be adjusted within limits.

- Car seats, which have been tested and approved by us, are suitable.
model list.

3. We recommend positioning the car seats as follows.

When using on the front seat:

- ▶ Slide the front seat as far back as possible.

When using on the rear seat:

- ▶ Slide the back seat as far back as possible.
- ▶ Slide the front seat as far forwards as possible.

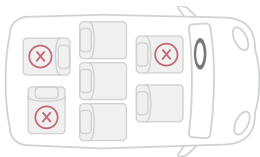

2.2.2 Attach insertion aids

The insertion aids simplify connecting the ISOFIX locking arms of the child seat to the ISOFIX installation bracket on the car seat. Some vehicles already have integrated insertion aids. Check whether your vehicle already has the required insertion aids. If the vehicle does not have them, Britax recommends using the insertion aids. These are included in the scope of delivery of the child seat.

Clamp the two insertion aids **2**, with the cut-out facing up, to the ISOFIX installation bracket **1** of the car seat.

For car seats with foldable backrests, the insertion aids must be removed before folding the backrest.

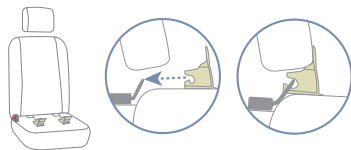
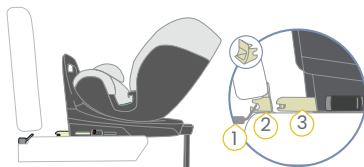

- ① ISOFIX Installation Bracket
- ② Insertion Aid
- ③ ISOFIX Locking Arms

2.2.3 Position child seat

- Make sure that the child seat is fitted with fastening type A (see “Changing to fastening type A (40 – 105 cm)”).
- Ensure that the Indicator Window 2 is set to the correct mode.
- Unfold the support leg 1 completely. The support leg 1 audibly locks in place.
- Pull out the head 3 of the support leg completely. The head 3 of the support leg audibly engages.
- Place the child seat on the selected car seat.



2.2.4 Fastening the ISOFIX

1. Press the locking button **4** and the release button **2** together and slide the ISOFIX locking arm **1** out as far as possible.
 - ✓ The ISOFIX locking arm **1** audibly locks in place.
2. Slide out the second ISOFIX locking arm **1** as far as possible, as well.
 - ✓ The second ISOFIX locking arm **1** audibly locks in place.
 - ✓ Both ISOFIX locking arms **1** are extended to the maximum.
3. Connect the ISOFIX locking arms **1** to the ISOFIX installation bracket on the car seat.
 - ✓ Both ISOFIX locking arms **1** audibly lock in place.
 - ✓ Both ISOFIX indicators **3** are green.
4. Clamp the ISOFIX connection by forcefully pushing the child seat into the backrest of the car seat.

NOTE: Clamping the child seat into the car seat reduces the amount of horizontal movement of the child seat.

The smaller the possible movement, the better the child will be protected.

WARNING Risk of injury from unsecured child seat. Make sure that both ISOFIX locking arms are fully locked in place. Both ISOFIX indicators must be green



5. Increase the tension of the ISOFIX connection by forcefully pushing forwards on the base.

NOTE: We recommend pushing the base alternately to the left and right.

6. Check that the ISOFIX locking arms **1** are both retracted to the same distance.

NOTE: The positions of the ISOFIX locking arms are shown on the product using numbers. These numbers are located above the ISOFIX indicators. Both ISOFIX indicators must show the same number.

7. Check that the ISOFIX locking arms **1** are connected to the ISOFIX installation brackets on both sides by pulling at the child seat.

If neither of the ISOFIX locking arms **1** comes loose, they are both connected to the vehicle.

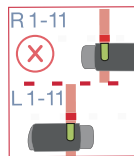
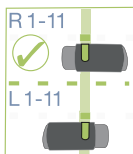

2.2.5 Setting support leg

1. Make sure that the head **2** of the support leg is still extended.
2. Make sure that the support leg **1** is still folded out.
3. Keep holding the adjustment button **3** depressed.
4. Extend the support leg **1** to the floor of the vehicle.
5. Release the adjustment button **3**.
 - The adjustment button **3** audibly locks in place.
 - The support leg indicator **4** is green.
 - The bottom of the base is on the seat of the car seat
6. Ensure the Indicator Window **5** shows A 40 - 105 cm.

WARNING Risk of injury if the support leg is not stable.

Never place objects underneath the support leg.

Make sure that the support leg is standing stably on the floor of the vehicle.

7. Make sure that the support leg **2** does not raise the bottom of the base from the surface of the car seat.

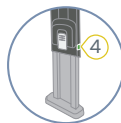
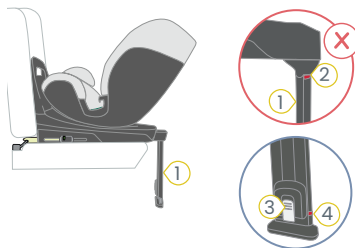

- 1** Support Leg
- 2** Support Leg head
- 3** Adjustment Button
- 4** Support Leg Indicator
- 5** Indicator Window

2.3 Secure child seat B (100 – 125 cm)

2.3.1 Select seat

1. Note and observe the vehicle handbook.

NOTE: Only car seats arranged in the direction of travel are approved for use.

2. Select a suitable seat.

- Car seats with i-Size approval are suitable.

NOTE: In rare cases, the child seat on car seats with i-Size approval can only be adjusted within limits.

- Car seats, which have been tested and approved by us, are suitable.

3. We recommend positioning the car seats as follows.

When using on the front seat:

- Slide the front seat as far back as possible.

When using on the rear seat:

- Slide the back seat as far back as possible.
- Slide the front seat as far forwards as possible.

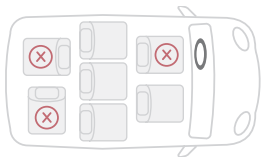

2.3.2 Attach insertion aids

The insertion aids simplify connecting the ISOFIX locking arms of the child seat to the ISOFIX installation bracket on the car seat. Some vehicles already have integrated insertion aids. Check whether your vehicle already has the required insertion aids. If the vehicle does not have them, Britax recommends using the insertion aids. These are included in the scope of delivery of the child seat.

Clamp the two insertion aids **2**, with the cut-out facing up, to the ISOFIX installation bracket **1** of the car seat.

For car seats with foldable backrests, the insertion aids **2** must be removed before folding the backrest.

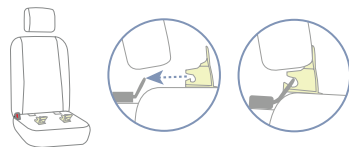
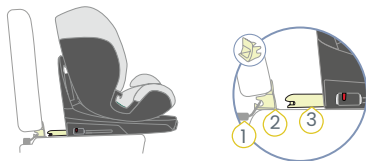

- ① ISOFIX Installation Bracket
- ② Insertion Aid
- ③ ISOFIX Locking Arms

2.3.3 Position child seat

1. Make sure that the child seat is fitted with fastening type B (see “Changing to fastening type B (100 – 125 cm)”)
2. Make sure that the support leg 1 is folded in.
3. Make sure that the head 2 of the support leg is retracted.
4. Place the child seat on the selected car seat.
5. Ensure the Indicator Window 3 shows - B 100-125 cm.

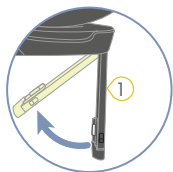
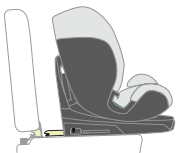

① Support Leg

② Head of the Support Leg

③ Indicator Window

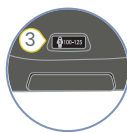
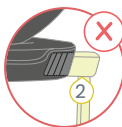

2.3.4 Fastening the ISOFIX

1. Press the fastening button **4** and the release button **2** together and slide the ISOFIX locking arm **1** out as far as possible.
 - The ISOFIX locking arm **1** audibly locks in place.
2. Slide out the second ISOFIX locking arm **1** as far as possible, as well.
 - The second ISOFIX locking arm **1** audibly locks in place.
 - Both ISOFIX locking arms **1** are extended to the maximum.
3. Connect the ISOFIX locking arms **1** to the ISOFIX installation bracket on the car seat.
 - Both ISOFIX locking arms **1** audibly lock in place.
 - Both ISOFIX indicators **3** are green.

WARNING Risk of injury from unsecured child seat.

Make sure that both ISOFIX locking arms are fully locked in place. Both ISOFIX indicators must be green.

4. Clamp the ISOFIX connection by forcefully pushing the child seat into the backrest of the car seat.

NOTE: Clamping the child seat into the car seat reduces the amount of horizontal movement of the child seat.

The smaller the possible movement, the better the child will be protected.

5. Increase the tension of the ISOFIX connection by

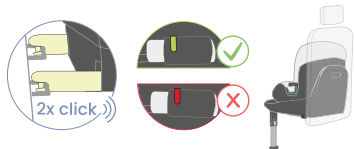
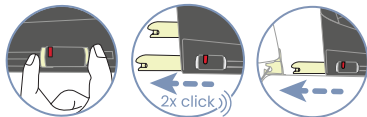
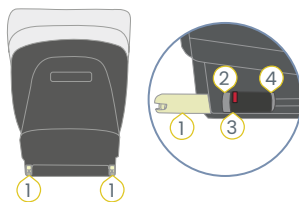

- 1** ISOFIX Locking Arms **3** ISOFIX Indicator
2 Release Button **4** Fastening Button

forcefully pushing forwards on the base.

NOTE: We recommend pushing the base alternately to the left and right.

6. Check that the ISOFIX locking arms **1** are both retracted to the same distance.

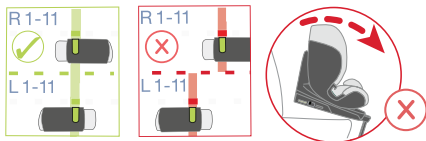

NOTE: The positions of the ISOFIX locking arms are shown on the product using numbers. These numbers are located above the ISOFIX indicators. Both ISOFIX indicators must show the same number.

7. Check that the ISOFIX locking arms **1** are connected to the ISOFIX installation brackets on both sides by pulling at the child seat.
- If neither of the ISOFIX locking arms **1** comes loose, they are both connected to the vehicle.

2.3.5 Secure seat belt

1. Set the headrest 2 to the highest position.
2. Pass the diagonal belt 1 through the belt holder 3 of the headrest 2.

WARNING Risk of injury if belt fitted incorrectly. The diagonal belt must face away from the alignment of the child seat. Other belt routes impair the protective effect.

- Check the belt route.
 - Make sure that diagonal belt faces against the direction of the child seat.
 - Do not use the child seat on the car seat if the belt route faces forwards.
3. Engage the buckle tongue 4 in the seat belt lock 5.
 4. Place the lap belt in both belt guides.
 5. Place the diagonal belt 1 on the side of the seat belt lock 5 into the belt guide.

WARNING Risk of injury if forces are transferred incorrectly.

- Check the position of the seat belt lock.
- Do not use the child seat on the car seat if the seat belt lock is in the area of the belt guide.



① Diagonal Belt

④ Buckle Tongue

② Headrest

⑤ Seat Belt Lock

③ Belt holder

3 Buckling in and unbuckling

3.1 Buckle child in A (40 – 105 cm)

Warning Risk of injury from front airbag

Airbags are designed to protect adults. The use of a front airbag when a seat is facing backwards can lead to serious or fatal injuries.

- Disable front airbag.
- Never use the seat facing backwards with an active front airbag.
- Note and observe the instructions in the vehicle handbook.

Warning Risk of injury from slack straps

Slack straps are areas of the seat belt that lie loosely against the child's body. Slack straps have a negative impact on the protective function.

- Ensure that the straps are tight and not twisted.
- The child should not wear thick clothing under the belt.

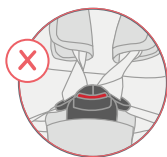
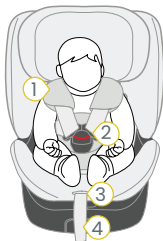

- ① Shoulder Straps
- ② Harness Buckle
- ③ Adjustment Button
- ④ Adjustment Belt

1. Make sure that the child seat is secure with fastening type A (see "Installation", page 10).
2. To loosen the belt, press the adjustment button **3** and pull both shoulder straps **1** forwards at the same time.
3. Open the harness buckle **2** by pressing the red button.
4. Place the harness buckle **2** at the front.
5. Never leave the child unsupervised in the seat.
6. Place the shoulder straps **1** over the child's shoulders.

WARNING Risk of injury if child is secured incorrectly.

Make sure that the shoulder straps are not twisted or reversed.

7. Bring the two buckle tongues **5** together.
8. Insert the joined buckle tongues **5** into the harness buckle **2**.
- ✓ The buckle tongues **5** audibly lock in place.
9. To prevent slack straps, pull the shoulder straps **1**.
10. Pull at the adjustment belt **4** until the shoulder straps **1** are tight to the child's body.

3.2 Check before every journey A (40 – 105 cm)

To protect your child, check the following points before each car journey.

1. The child seat and child are secured with fastening

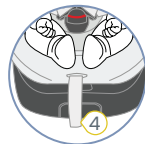
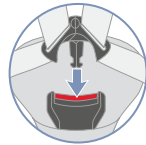
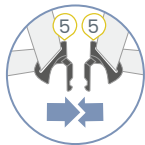

4 Adjustment Belt

5 Buckle Tongues

WARNING Risk of injury to the abdomen (soft area in the stomach). Ensure that the hip straps are positioned as low as possible over your child's hips.

- type A.
- Both ISOFIX locking arms are locked into the ISOFIX installation brackets.
 - Both ISOFIX locking arms are extended the same distance.
 - Both ISOFIX indicators are green.
 - The support leg is stable on the floor of the car.
 - The protection indicator on the support leg is green.
 - The seat audibly locks.
 - Ensure the Indicator Window shows A 40 - 105 cm.
 - The straps are tight to the child's body without restricting the child.
 - The headrest is correctly adjusted.
 - The shoulder pads are in the right position on the child.
 - The straps are not twisted and not reversed.
 - If using the seat facing backwards, the front airbag is disabled.
 - The child seat is used as intended in respect of the age and size of the child.

WARNING Risk of injury due to omitted checks.

During the journey, the child may try to unbuckle the belt

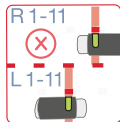
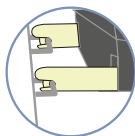

or loosen the child seat. If the child is not secured in the child seat, this can lead to serious or even fatal injuries.

If the child or the child seat is not fastened:

- Immediately stop the vehicle as soon as the traffic situation allows.
- Make sure that the child seat is secured.
- Ensure that the child is buckled in.

For the wellbeing of your child, on long journeys we recommend taking regular breaks. Give your child the opportunity to move.



3.3 Unbuckle child A (40 – 105 cm)

1. Open the harness buckle 1 by pressing the red button.
2. Take the child out of the child seat.

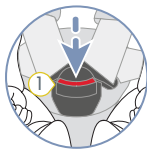

① Harness Buckle

4 Use the insert for newborn babies

You must use the insert for newborn babies for body sizes up to 75 cm.

1. Open the harness buckle by pressing the red button.
2. To loosen the belt, press the adjustment button and pull both shoulder straps forwards at the same time.
3. Extend the headrest to its maximum.
4. Place the insert for newborn babies **2** into the child seat.
5. Place both shoulder Pads **1** over the insert for newborn babies **2**.
6. Hang the two loops **4** in the belt holder **3**.
7. Hang the two plastic hooks **5** in the loops **1** on the cover of the headrest.
8. Guide the harness buckle and the padded crotch through the recesses on the lower part of the insert for newborn babies **2**.
9. The head pillow of Baby insert can not be removed in any circumstance during the use of the seat.

1 Shoulder Pads

2 Insert for Newborn Babies

3 Belt Holder

4 Loops

5 Plastic Hooks

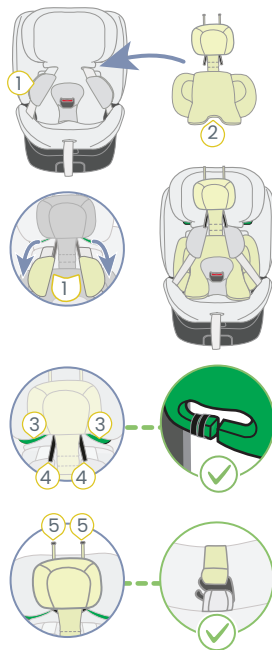

5. Buckle child in B (100 – 125 cm)

Risk of injury from slack straps

Slack straps are areas of the seat belt that lie loosely against the child's body. Slack straps have a negative impact on the protective function.

- Ensure that the straps are tight and not twisted.
- The child should not wear thick clothing under the belt.

1. Make sure that the child seat is secured.
2. Engage the buckle tongue 1 in the seat belt buckle 2.
3. Place the lap belt 4 into the two belt guides 5.

WARNING Make sure that the lap belt is not twisted.

4. Place the diagonal belt 3 on the side of the seat belt lock 2 into the belt guide 5.

WARNING Risk of injury to the abdomen (soft area in the stomach).

Ensure that the lap belt is as low as possible over your child's hips.

5. Feed the lap belt 4 into the belt guide.

WARNING Risk of injury due to incorrect fastening.

6. Tighten the seat belt by pulling on the diagonal belt 3.



① Buckle Tongue

② Seat Belt Lock

③ Diagonal Belt

④ Lap Belt

⑤ Belt Guide



5.1 Check before every journey B (100 – 125 cm)

To protect your child, check the following points before each car journey.

7. The child seat and the child are secured either with fastening type B.
8. The headrest is correctly adjusted.
9. The lap belt passes through both belt guides.
10. The diagonal belt is to the side of the seat belt lock in the belt guide.
11. The diagonal belt is in the diagonal belt holder.
12. The button for the belt holder is closed.
13. The diagonal belt passes centrally over the child's collar bone
14. The diagonal belt does not pass over the child's neck.
15. The 3-point seat belt is not twisted.
16. The child seat is used as intended in respect of the age and size of the child .
17. Both ISOFIX locking arms are locked into the ISOFIX installation brackets.
18. Both ISOFIX locking arms are in the same position.
19. Both ISOFIX indicators are green.

WARNING

WARNING Risk of injury due to omitted checks.

During the journey, the child may try to unbuckle the belt or loosen the child seat. If the child is not secured in the child seat, this can lead to serious or even fatal injuries.

If the child or the child seat is not fastened:

- Immediately stop the vehicle as soon as the traffic situation allows.
- Make sure that the child seat is secured.
- Ensure that the child is buckled in.

For the wellbeing of your child, on long journeys Britax recommends taking regular breaks. Give your child the opportunity to move.

5.2 Unbuckle child B (100 – 125 cm)

WARNING

WARNING Risk of injury from unsecured objects

In the case of an emergency stop or accident, the unsecured child seat may cause injury to other occupants in the vehicle.

- Ensure that the child seat product is always secured when it is in the vehicle, even if no child is being transported.
- To unbuckle the child, press the release button on the seat belt lock.

6 Changing the fastening type

6.1 Changing to fastening type B (100 – 125 cm)

We recommend using fastening type A for as long as possible.

6.1.1 Preparing the change

1. Open the harness buckle 5.
2. To loosen the belt, press the adjustment button 4 and pull both shoulder straps 2 forwards at the same time.

The shoulder pads are not connected to the shoulder straps. If you pull on the shoulder pads, the belt is not loosened. Only pull on the shoulder straps.

3. Extend the headrest 1 to its maximum.
4. Place the buckle tongue in the belt guides.

6.1.2 Loosen shoulder straps from the headrest.

1. Push the shoulder straps 2 away from the cover the headrest 3.
2. Fold the cover of the headrest 3 up.

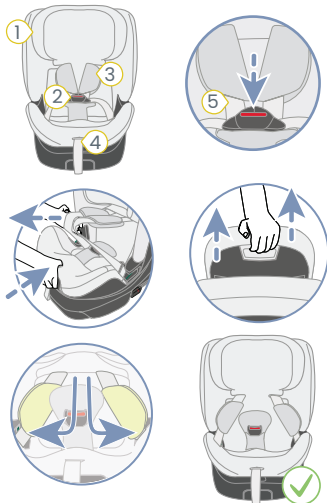

- ① Headrest ④ Adjustment Button
② Shoulder Strap ⑤ Harness Buckle
③ Shoulder Pads

6.1.3 Stow harness buckle

1. Pull the padded crotch **2** away from the harness buckle **1**.
2. Pull the harness buckle **1** through the slot.
3. Fold the cover **3** forwards.
4. Open the compartment **3**.
5. Stow the harness buckle **1** in the compartment **3**.

NOTE: The padded crotch **2** cannot be stowed in the compartment **4**.

6. Close the compartment **4**.



- ① Harness Buckle ③ Cover
② Padded Crotch ④ Compartment

6.1.4 Stow padded crotch

1. Pull the padded crotch **1** away from the slot **2**.
2. Place the padded crotch **1** into the storage bag behind the headrest fabric cover **3**.

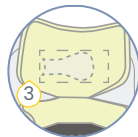
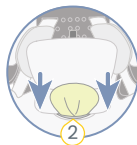
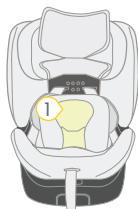

- ① Padded Crotch
- ② Slot
- ③ headrest fabric cover

6.1.5 Stow 5-point seat belt

1. Place the buckle tongues 3 into the recesses 2.
 2. Open the two shoulder pads 1.
 3. Loosen the shoulder pads 1.
 4. Slide the shoulder pads 1 to the side under the cover the backrest.
 5. Tighten the harness by pulling on the adjustment belt 4.
 6. Fold back the cover 5.
 7. Fold down the cover 6 of the headrest.
- ✓ The child seat is fitted with fastening type B.

- ① Shoulder Pads
- ② Recess
- ③ Buckle Tongue
- ④ Adjustment Belt
- ⑤ Cover
- ⑥ Cover of the headrest

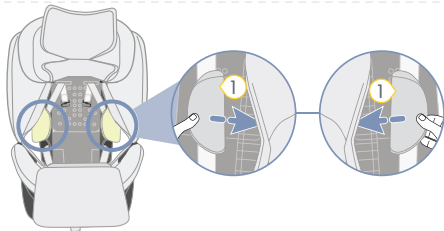
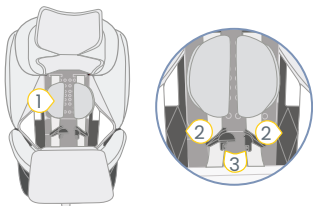

6.2 Changing to fastening type A (40 – 105 cm)

6.2.1 Preparing the change

1. Fold the cover of the headrest **2** up.
2. Pull the cover **3** forwards.

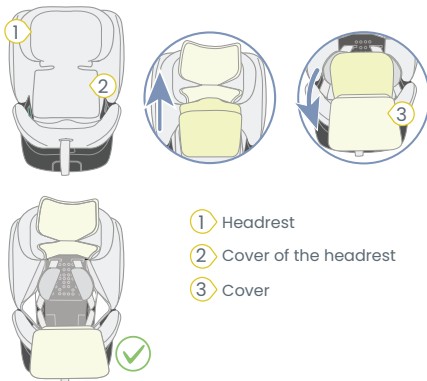

6.2.2 Attach 5-point harness

1. To loosen the belt, press the adjustment button and pull both shoulder straps forwards at the same time.
2. Remove the buckle tongues **3** from the recesses.
3. Remove the shoulder pads **1** from the side bolsters.
4. Attach the shoulder pads **1**.

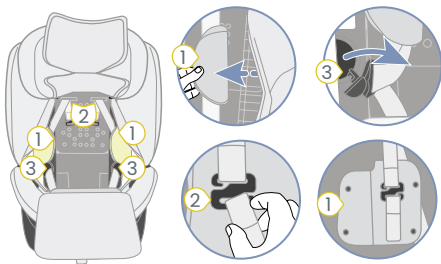

1 Shoulder Pads

3 Buckle Tongue

2 Hooks

6.2.3 Attach padded crotch

1. Remove the Padded Crotch **1** from the storage bag behind the headrest fabric cover.
2. Insert the Padded Crotch **1** through the slot **2** of the fabric cover.
3. Adjust the fabric cover properly.

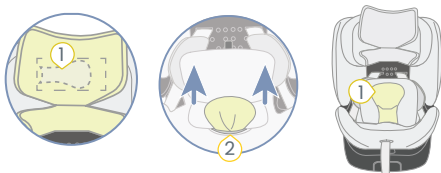

1 Padded Crotch

2 Slot

6.2.4 Attach harness buckle

1. Open the compartment 1.
2. Remove the harness buckle 2.
3. Close the compartment 1.
4. Pull the harness buckle 2 through the slot 5.
5. Pull the harness buckle 2 through the padded crotch 3.
6. Slide the padded tongue 4 through the slot 5.

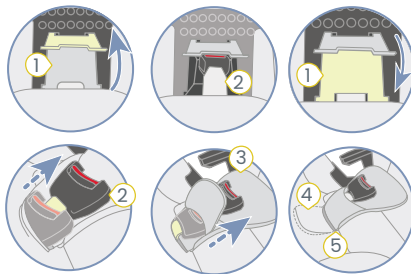

- ① Compartment ③ Padded Crotch
② Harness Buckle ④ Padded Tongue
⑤ Slot

6.2.5 Connect shoulder straps with the headrest.

1. Fold down the cover of the headrest 1.
 2. Place the shoulder straps 2 into the slots of the headrest.
- ✓ The child seat is fitted with fastening type A.

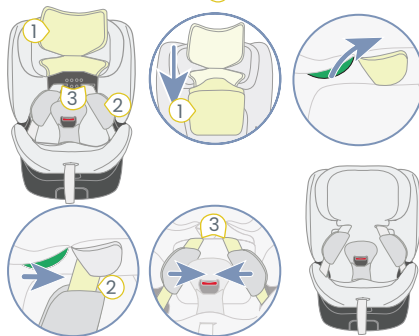

- ① Headrest Cover ③ Slots
② Shoulder Straps

7 Adjust Seat

WARNING

Risk of injury from unsecured seat

If you press the adjustment button, you unlock the angle and rotation mechanism. If one of the two mechanisms is unlocked, in the event of an accident this can lead to serious or even fatal injuries.

- ▶ Make sure that the angle mechanism is engaged.
- ▶ Make sure that the rotation mechanism is engaged.

You can use the seat at different angles of inclination.

You can rotate the seat on the base. The rotary function allows the following uses:

- Easier entry and exit for the child (see “Boarding and exit function”).
- Change in direction of travel (see “Change direction of travel”).

7.1 Adjusting the seat angle

1. Pull the adjustment handle 1 forwards and slide the seat 2 to the desired position.
 2. Release the adjustment handle 1.
 3. To check that the angle mechanism has engaged, pull on the seat 2.
- ▶ The angle mechanism engages with a "Click" sound.
4. To check the mechanism is engaged, turn the seat 2.
- ▶ The rotation mechanism engages with a 'click' sound.



⚠ WARNING

Risk of injury due to untensioned belts

If the product is already secured in the vehicle with a 3-point seat belt: If you adjust the inclination of the backrest, belt slack may occur in the vehicle belt.

- ▶ Make sure that the vehicle seat belt is tightened and not twisted.

7.2 Change direction of travel

WARNING

Risk of injury from front airbag

Airbags are designed to protect adults. The use of a front airbag when a seat is facing backwards can lead to serious or fatal injuries.

- Disable front airbag.
- Never use the seat facing backwards with an active front airbag.
- Note and observe the instructions in the vehicle handbook.

WARNING

Risk of injury if facing in the wrong direction

The alignment of the seat is critical for the safety of the child. If used incorrectly, even just braking can lead to serious or even fatal injuries.

- Do not use a front-facing child seat if your child is smaller than 9kg.
- Britax recommends use the child seat facing backwards for as long as possible.
- Before each car journey, ensure that the rotatable seat of the child seat is locked in place.

1. Pull the adjustment handle **1** forwards.
 2. To change the direction of travel, turn the seat **2** to the desired direction.
 3. Release the adjustment handle **1**.
 4. To check the mechanism is engaged, turn the seat **2**.
- ✓ The rotation mechanism engages with a 'click' sound.
5. To check that the angle mechanism has engaged, pull on the seat **2**.
- ✓ The angle mechanism engages with a "Click" sound.

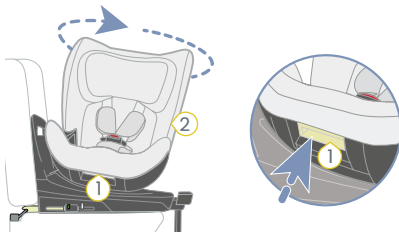

① Adjustment Button

② Seat

7.3 Boarding and exit function

WARNING

Risk of injury from front airbag

Airbags are designed to protect adults. The use of a front airbag when a seat is facing backwards can lead to serious or fatal injuries.

- Disable front airbag.
- Never use the seat facing backwards with an active front airbag.
- Note and observe the instructions in the vehicle handbook.

WARNING

Risk of injury if facing in the wrong direction

The alignment of the seat is critical for the safety of the child. If used incorrectly, even just braking can lead to serious or even fatal injuries.

- Do not use a front-facing child seat if your child is smaller than 76 cm or younger than 15 months.
- Britax recommends use the child seat facing backwards for as long as possible.
- Before each car journey, ensure that the rotatable seat of the child seat is locked in place.

1. Pull the adjustment handle **1** forwards.
 2. To make entry and exit easier, turn the seat **2** towards car door.
 3. Release the adjustment handle **1**.
 4. Secure the child see "Installation".
- ▶ INFO Alternatively, you can use this position of the seat to remove the child.
5. Secure the seat **2** by turning it back.
 6. To check the mechanism is engaged, turn the seat **2**.
 - The rotation mechanism engages with a 'click' sound.
 7. To check that the angle mechanism has engaged, pull on the seat **2**.
 - The angle mechanism engages with a "Click" sound.

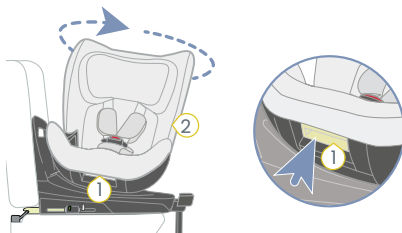

① Adjustment Button

② Seat

WARNING

Risk of injury due to untensioned belts If the product is already secured in the vehicle with a 3-point seat belt: If you adjust the inclination of the backrest, belt slack may occur in the vehicle belt.

- Make sure that the vehicle seat belt is tightened and not twisted.

7.4 Tighten Adjustment strap

1. Grasp Adjustment strap 1, pull the Adjustment strap 1 forward slowly.
2. When the Shoulder pads 2 and the child can accommodate two adult fingers, release the Adjustment strap 1, that is the tightness of the shoulder straps are the most suitable.

NOTE: The height of the shoulder strap should be at the same level or a little higher than your child's shoulder.

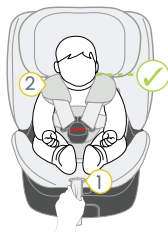

- 1 Adjustment strap
- 2 Shoulder Pads

7.5 Adjust headrest

The headrest setting depends on the type of securing (see “Fastening type A and B”).

7.5.1 Set headrest A (40 – 105 cm)

1. Check that the headrest **1** is adjusted correctly.

If the shoulder straps are at or slightly above the shoulder height of the child, the headrest is positioned correctly.

- If the headrest is not positioned correctly, perform the following steps.
2. To loosen the belt, press the adjustment button **3** and pull both shoulder straps **5** forwards at the same time.

The shoulder pads are not connected to the shoulder straps. If you pull on the shoulder pads, the belt is not loosened. Only pull on the shoulder straps.

3. Keep the release button **6** pressed and slide the headrest **1** to the correct shoulder height.
4. Check that the headrest **1** is locked correctly in place by pushing the headrest **1** down.
5. Headrest **1** is adjusted correctly the same level or a little higher than your child’s shoulder.

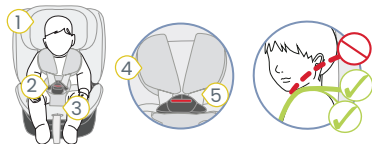

- | | |
|----------------------------|--------------------------|
| 1 Headrest | 4 Shoulder Pads |
| 2 Harness Buckle | 5 Shoulder Straps |
| 3 Adjustment Button | 6 Release Button |

7.5.2 Set headrest B (100 – 125 cm)

1. Check that the headrest **1** is adjusted to the size of the child.

If the headrest is two finger-widths above the shoulder height of the child, the headrest is positioned correctly.

- If the headrest is not positioned correctly, perform the following steps.
2. Keep the release button **2** pressed and slide the headrest **1** to the correct shoulder height.
 3. Check that the headrest **1** is locked correctly in place by pushing the headrest **1** down.
 4. Headrest **1** is adjusted to the size of the child.

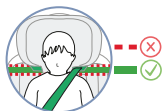

① Headrest

② Release Button

8 Cleaning and maintenance

8.1 Cover

8.1.1 Remove cover

The cover of the child seat comprises multiple parts.

1. Loosen all fastenings.
2. Pull the individual parts of the cover from the child seat.

8.1.2 Clean cover

You can remove the following covers and wash them in the washing machine:

- Cover of the headrest.
- Seat cover.
- Note the instructions on the covers washing label.
- Wash the cover at 30 °C with a mild detergent on the washing machine's fine wash program.
- You can remove the shoulder pads and wash them with like warm soapy water.
- You can clean the plastic parts and straps with soapy water.
- Do not use strong cleaning agents (such as solvents).

8.1.3 Attach cover

WARNING

Risk of injury due to missing seat cover

The seat cover is an integral safety component of the child seat. If the seat cover is not used, this may lead to serious or even fatal injuries.

- Never use the child seat without the correct seat cover.
- Only use the original Britax replacement seat cover.
- Replacement seat covers are available from your retailer.
- To fit the cover again, follow the steps in the reverse order

WARNING

Risk of injury due to twisted straps.

Twisted straps have a negative impact on the protective function.

- Ensure that the straps are tight and not twisted.
- Ensure that the straps are fitted correctly in the belt slots of the cover.
- To fit the cover again, follow the steps in the reverse order

8.2 Shoulder pads

8.2.1 Remove shoulder pads

1. To loosen the belt, press the adjustment button **1** and pull the two shoulder straps **4** forwards at the same time.
- ▶ The shoulder pads are not connected to the shoulder straps. If you pull on the shoulder pads, the belt is not loosened. Only pull on the shoulder straps.
2. Open the shoulder pads **2** using the push-buttons on the side.
3. Unhook the revealed belt loops of the shoulder pads **2** from the hooks **3**.

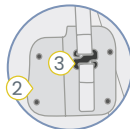

8.2.2 Attach shoulder pads

WARNING

Risk of injury due to missing shoulder pads.

The shoulder pads are an integral safety component of the child seat. If the shoulder pads are not used, this may lead to serious or even fatal injuries.

- Never use the child seat without the correct shoulder pads.
- Only use the original Britax shoulder pads.

- 1** Adjustment button
- 2** Shoulder Pads
- 3** Hooks
- 4** Shoulder Straps

1. Open the shoulder pad **3** on the hook **4**.
2. Place the shoulder straps into the shoulder pad **3**.
3. Close the shoulder pads **3**.
4. Repeat the steps for the other shoulder pad.

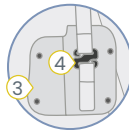

⚠ WARNING

Risk of injury due to twisted shoulder pads

Twisted straps have a negative impact on the protective function.

- Make sure that the shoulder pads and straps are not twisted or reversed.
- Ensure that the shoulder straps are in the shoulder pads.

1 Harness Buckle

3 Shoulder Pads

2 Adjustment button

4 Hooks

8.2.3 Clean belt lock

1. Soak the belt lock for at least an hour. Use warm water with washing-up liquid.
 - ▶ Use a small bowl to clean the harness buckle in.
2. Thoroughly rinse and dry the harness buckle.

8.3 Troubleshooting

8.3.1 Harness buckle

The harness buckle is an integral part of the child seat and fulfills important functions for securing the child. Make sure that the harness buckle works perfectly.

Possible problems:

- The buckle tongues are only pushed out of slowly after pressing the red unlocking button.
- The buckle tongues no longer lock in place.
- The buckle tongues lock in place but not audibly.
- The buckle tongues can only be pushed into the harness buckle with difficulty.
- It takes a lot of force to open the harness buckle.

Solution:

- ✓ Clean the harness buckle (see “Clean belt lock”, page 52).

8.3.2 ISOFIX connection

The ISOFIX connection is an integral part of the child seat and fulfills important functions of the child seat. Make sure that the ISOFIX connection works perfectly.

Possible problem:

- The ISOFIX locking arms of the child seat cannot be connected to the ISOFIX installation brackets of the vehicle.

Solution:

- Clean the vehicle’s ISOFIX installation bracket.

9 Storage and disposal

9.1.1 Storage

If you do not use the product for a longer period, please note the following information.

- ▶ Store product in a secure and dry location.
- ▶ Keep the storage temperature between 20 and 25 °C.
- ▶ Do not lean heavy objects on the product.
- ▶ Do not store product directly next to sources of heat or in direct sunlight.
- ▶ Protect the product from moisture, wet conditions, liquids, dust and salt spray.

9.1.2 Disposal

- ▶ Do not dismantle the product.
- ▶ Prevent third parties from using the defective product.

Cut through the shoulder straps.

Remove the approved label.

- ▶ Please follow the disposal regulations applying in your country.

10 Installing and Removing Canopy (If fitted)

10.1.1 Install Canopy

1. Insert the canopy **1** into socket found on the front of the seat **2**.
2. Fit the canopy **1** over the seat with elastic **4** at the end.



10.1.2 Remove Canopy

3. To remove the canopy, press the canopy rod button, pull the canopy rod **3** out of the socket **2** on both sides of the front of the seat.
4. Lift the elastic **4** at the end of the seat away from the canopy **1**.

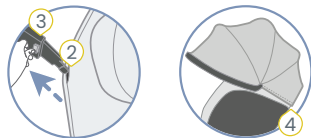

- 1 Canopy
- 2 Socket
- 3 Canopy Rod
- 4 Elastic

11 Fan Operation instruction

11.1 Specification parameters

- ▶ Power supply by Cigarette lighter: rated voltage 12V.
 - ▶ Power supply by Type-C: rated voltage 12V.
-

11.2 Type-C connection

- ▶ Insert Type-C plug **3** into the Typy-C outlet in the car, and connect cable plug **2** into the seat outlet **1**.
-

11.3 Cigarette lighter connection

- ▶ Insert cigarette lighter plug **4** into the car cigarette lighter, and the plug **2** into the seat outlet **1**, then turn on the cigarette lighter switch button to turn the fan.
-

NOTE:

1. The Type-C cable is only compatible with vehicles that support PD protocol. Please consult your vehicle manufacturer for details.
2. Please choose the 11.2 or 11.3 connection method based on your car configuration to turn on the fan.

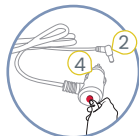
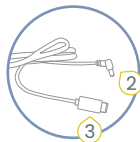

- ① Seat outlet
- ② Cable plug
- ③ Type-C plug
- ④ Cigarette lighter plug

Declaration of Toxic and Harmful Substances in Electronic Products

Component Name	Toxic and Harmful substances or elements					
	Lead (Pb)	Mercury (Hg)	Cadmium (Cd)	Hexavalent chromium (Cr ⁶⁺)	Polybrominated biphenyls (PBB)	Polybrominated diphenyl ethers (PBDE)
Plug and flexible cord	○	○	○	○	○	○
Shell and protective door	○	○	○	○	○	○
Circuit board components	×	○	○	○	○	○
Insert sleeve	○	○	○	○	○	○
Packing	○	○	○	○	○	○

- : The content of the toxic and harmful substance in all homogeneous materials of the component is below the limit requirements specified in SJ/T11363-2006 standard.
- ×: The content of the toxic and harmful substance in at least on homogeneous material of the component exceeds the limit requirements specified in SJ/T11363-2006 standard.



The “environmental protection use period” of the product is 10 years. Toxic and harmful substances or elements contained in electronic in formation products will not leak under normal use conditions, and the use’s use of this product will not cause serious pollution to the environment or serious damage to their person or property.

12 Warning Notice

Scope: 40-125 cm (New born-7 years old)

Warning Notice

40-105cm integral Universal ISOFIX

This Product is an i-Size child restraint system, It's approved according to GB27887-2024, for use in "i-Size compatible vehicle seating positions" as indicated by vehicle manufacturers in the vehicle user's manual.

100-125cm i-Size Booster seat

This is an i-Size booster seat, approved according to GB27887-2024, for use primarily in "i-Size seating positions" as indicated by vehicle manufacturers in the vehicle user's manual.

Warning

DO NOT USE BEFORE THE CHILD'S AGE EXCEEDS 15 MONTHS (Refer to instructions), The rear-facing child restraint system should not be installed on a seat where the airbag is active.

If in doubt, consult either the Child Restraint System manufacturer or the retailer.
This product implements GB27887-2024 «Child Restraint Systems for Power-driven vehicles»

13 Contact

If there are any questions, please get in touch:

Britax Childcare Hong Kong Limited

Unit 2303-2304, 23/F, Tower 1, Enterprise Square Five,

38 Wang Chiu Road, Kowloon Bay

Hong Kong

