

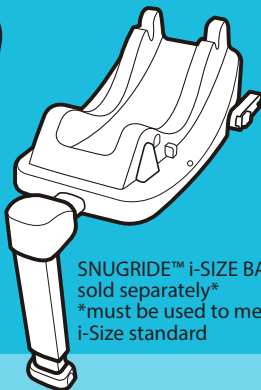

SNUGSESSENTIALS™ i-SIZE

ALL-IN-ONE CAR SEAT

IMPORTANT - KEEP FOR FUTURE REFERENCE

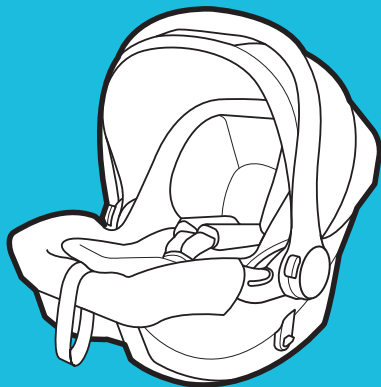

SNUGRIDE™ i-SIZE BASE
sold separately*
*must be used to meet
i-Size standard

EN

Owner's Manual
Parts List
Fitting Guide

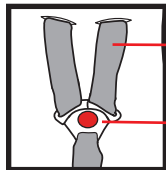
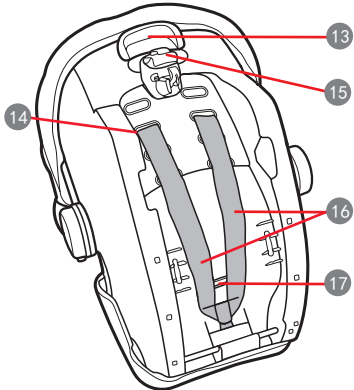
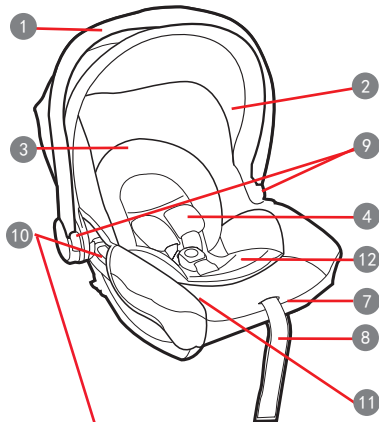

- ① Handle
- ② Hood
- ③ Head Support
- ④ Shoulder Harness
- ⑤ Harness Buckle
- ⑥ Shoulder Harness
- ⑦ Harness Adjustment Button
- ⑧ Adjustment Webbing
- ⑨ Handle Button
- ⑩ Side Guide
- ⑪ Instructional Manual (under Seat Covers)
- ⑫ Infant Insert

- ⑬ Stroller Fix Release Button
- ⑭ Harness Slot
- ⑮ Rear Guide
- ⑯ Shoulder Harness
- ⑰ Crotch strap

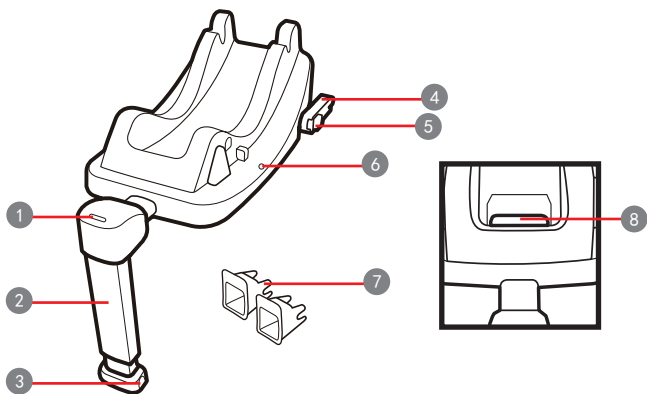

- ① Load Leg Indicator
- ② Load Leg
- ③ Load Leg Adjustment Button
- ④ ISOFIX Connector
- ⑤ ISOFIX Releasing Button
- ⑥ Shell Indicator
- ⑦ ISOFIX Guides
- ⑧ ISOFIX Adjustment Button

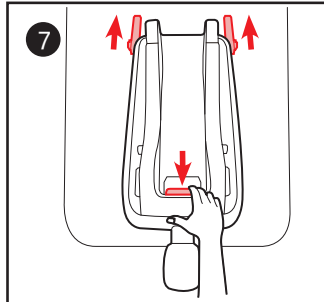
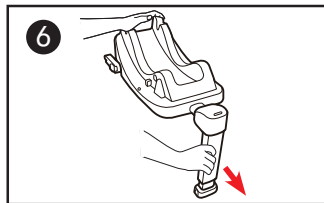
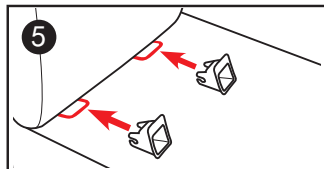
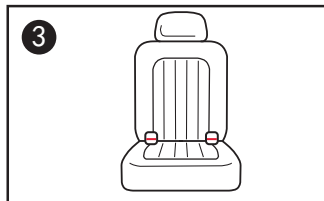
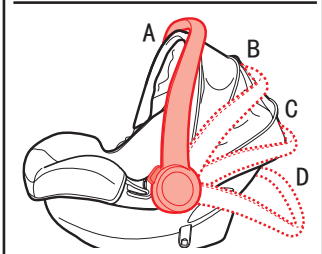
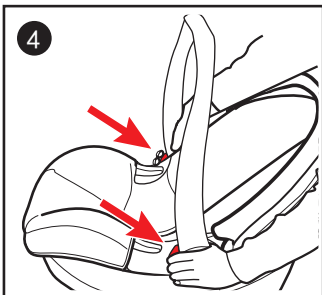

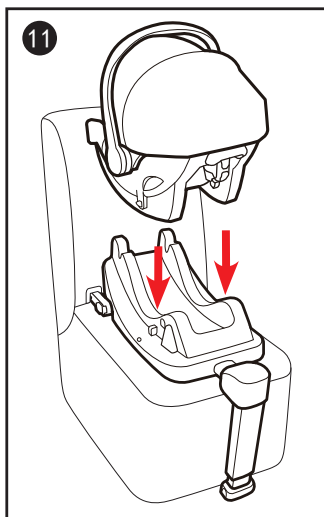
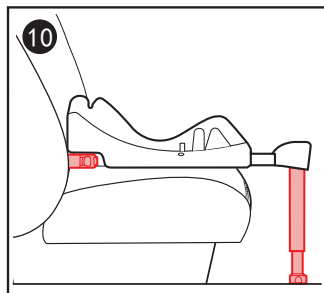
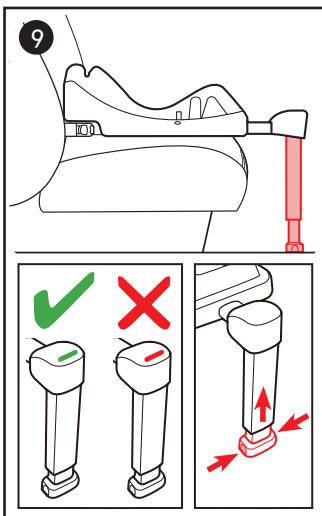
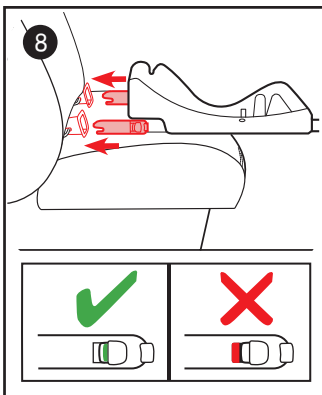

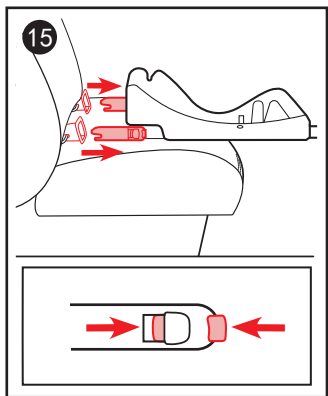
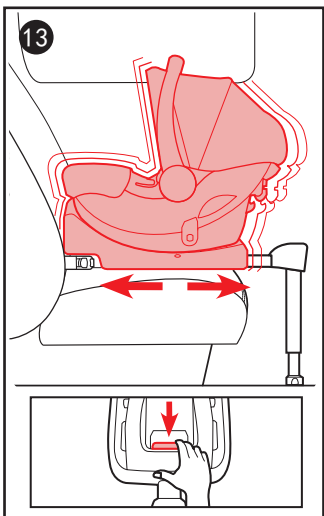
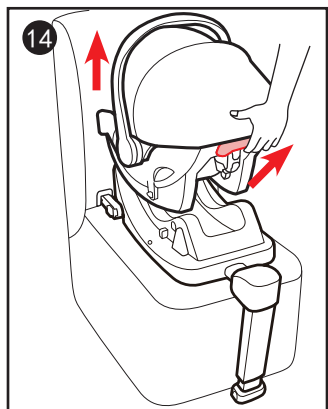
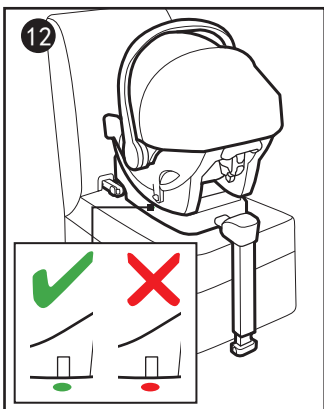

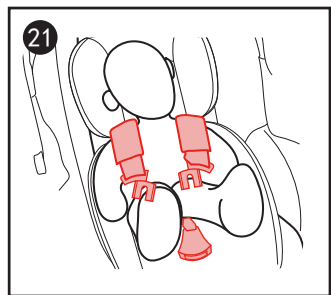
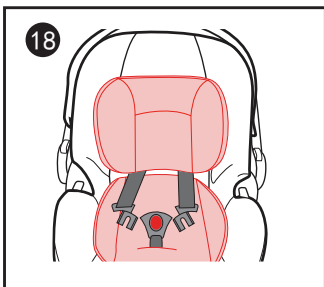
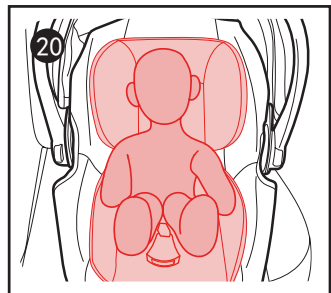
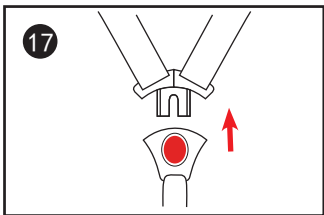
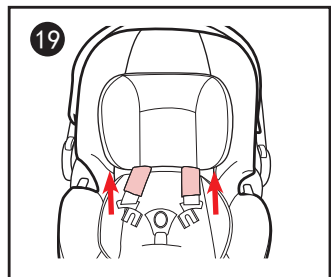
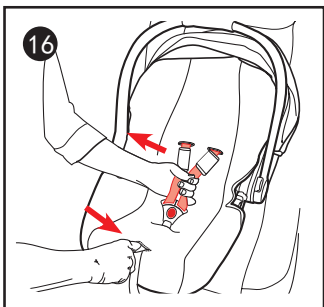

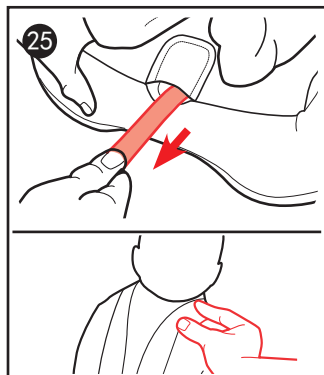
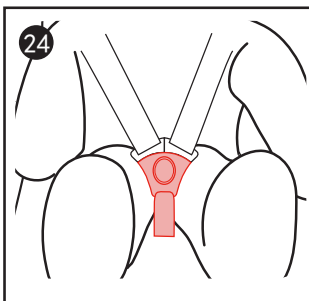
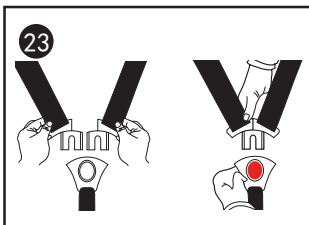
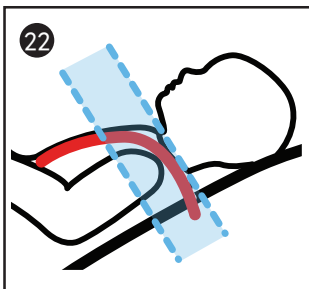

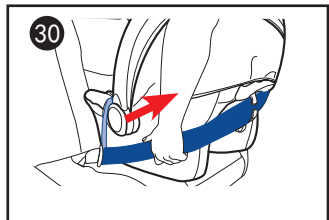
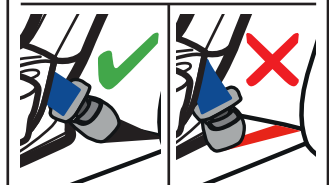
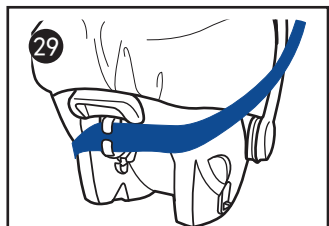
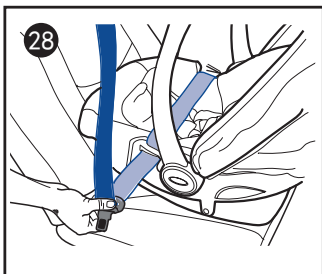
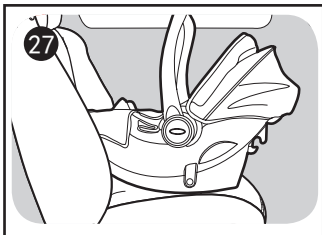
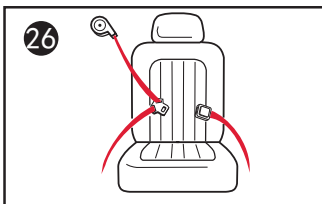

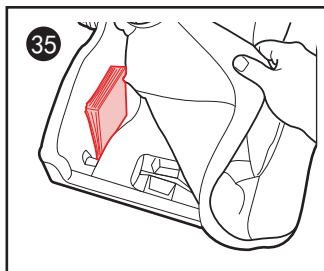
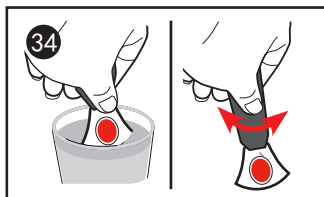
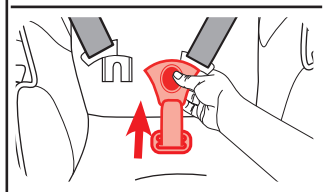
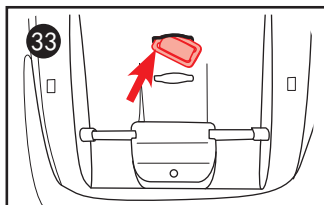
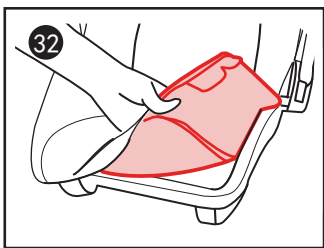
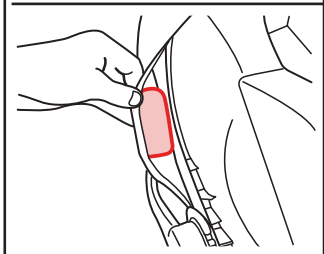
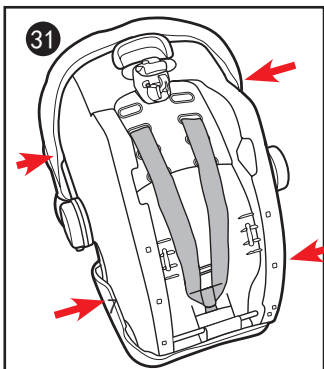

WARNING

Please check before you purchase this enhanced child restraint to make sure it can be installed properly in your vehicle.

NO enhanced child restraint can guarantee full protection from injury in an accident. However, proper use of this enhanced child restraint will reduce the risk of serious injury or death to your child.

To use this enhanced child restraint with the ISOFIX connections according to the ECE R129/02 Regulation, your child must meet the following requirements.

Child height 40cm-75cm/ Child weight $\leq 13\text{kg}$ (Child age < 12 months).

To use this infant carrier module with vehicle belt, your child must meet the following requirements. Child weight $\leq 13\text{kg}$ / Child age < 12 months.

Any straps of enhanced child restraint should be tightened and not twisted.

DO NOT install this enhanced child restraint without following the instructions in this manual or you may put your child at serious risk of injury or death.

NEVER leave your child unattended with this enhanced child restraint.

DO NOT make any modification to this enhanced child restraint or use it along with component parts from other manufacturers.

DO NOT use this enhanced child restraint if it has damaged or missing parts.

DO NOT have your child in large/oversized clothes because this may prevent your child from being properly and securely fastened by the shoulder harness straps and the crotch strap between the legs.

DO NOT leave this enhanced child restraint or other items unbelted or unsecured in your vehicle because an unsecured enhanced child restraint can be thrown around and may injure occupants in a sharp turn, sudden stop, or collision.

DO NOT place a rear-facing enhanced child restraint on front seat with air bag. Death or serious injury may occur. Please reference vehicle owner' s manual for more information.

NEVER use a second-hand enhanced child restraint or an enhanced child restraint whose history you do not know because it may have structural-

damage that compromises your child' s safety.

NEVER use ropes or any other substitutes to secure enhanced child restraint in vehicle or to secure child into enhanced child restraint.

DO NOT use this enhanced child restraint without the soft goods.

The soft goods should not be replaced with any besides the ones recommended by the manufacturer. The soft goods constitute an integral part of the enhanced child restraint performance.

DO NOT put anything other than the recommended inner cushions in this enhanced child restraint.

Be sure that the enhanced child restraint is installed in such a way that no part of it interferes with movable seats or in the operation of vehicle doors.

DO NOT continue to use this enhanced child restraint after it has suffered any type of crash, even a minor one. Replace immediately as there may be invisible, structural damage from the crash.

Remove this infant carrier module and base from the vehicle seat when it is not in regular use.

Consult the distributor for issues concerning maintenance, repair and part replacement.

To avoid the risk of falling out, always secure the child using the child harness when the child is placed in infant carrier module, even when the enhanced child restraint is not in the vehicle.

Before carrying the infant carrier module by hand, ensure that the child is fastened with the child harness, and that the

handle is correctly locked in a vertical position.

To avoid serious injury or death, NEVER place infant carrier module on elevated surface seat with child in it.

The parts of this enhanced child restraint should not be lubricated in any way.

Always secure child in enhanced child restraint, even on short trips, as this is when most accidents occur.

Please keep this enhanced child restraint away from sunlight, because it may be too hot for child's skin. Always touch the enhanced child restraint before placing child in it.

Product Information

"i-Size" (Integral Universal ISOFIX Enhanced Child Restraint Systems) is a category of Enhanced Child Restraint System for use in all i-Size seating position of a vehicle.

1. According to the ECE R129/02 Regulation, the product is a Universal ISOFIX Class ISO/D enhanced child restraint and should be fitted using the ISOFIX connections.
2. This is an "i-Size" Enhanced Child Restraint System. It is approved according to Regulation No.129, for use in, i-Size compatible vehicle seating positions as indicated by vehicle manufacturers in the vehicle users' manual.
3. If in doubt, consult either the Enhanced Child Restraint System manufacturer or the retailer.

It is approved to ECE R129/02 series of amendments, not all vehicle manufacture's handbooks list i-Size compatibility yet. This seat and base is also approved for use in ISOFIX compatible vehicles. Please refer to the vehicle manufacturer's website or consult your dealer.

It will fit vehicles with positions approved as i-Size ISOFIX positions (as detailed in the vehicle handbook), depending on the category of the enhanced child restraint and of the fixture.

Concerns on Installation

- 1 DO NOT install this enhanced child restraint on vehicle seats that face sideways or rearward with respect to the moving direction of the vehicle.

It is recommended to install this enhanced child restraint on the rear vehicle seat.

DO NOT install this enhanced child restraint on vehicle seats movable during installation.

- 2 DO NOT place rear-facing enhanced child restraint on front seat with air bag, because death or serious injury may occur. Please reference vehicle owner's manual for more information.
- 3 This infant carrier is suitable for vehicle seats with i-Size ISOFIX anchor points with the Base.

Handle Adjustment

- 4 To adjust the handle, squeeze the handle buttons on both sides to release it, and then rotate the handle until it clicks into any of the 4 positions.

The handle of the infant carrier module can be adjusted to 4 positions.

Position A Position for car, hand or stroller transportation.

Position B&C Rocking position.

Position D Baby chair position.

Installation with base

- 5 Fit the ISOFIX guides with the ISOFIX anchor points.

The ISOFIX guides can protect the surface of the vehicle seat from being torn. They can also guide the ISOFIX connectors.

- 6 Unfold the load leg from storage compartment.
- 7 Line up the ISOFIX connectors with the ISOFIX guides, and then click both ISOFIX connectors into the ISOFIX anchor points.
- 8 Make sure that both ISOFIX connectors are securely attached to their ISOFIX anchor points. There should be two audible clicks and the colors of the indicators on the both ISOFIX connectors should be completely green.

Check to make sure the base is securely installed by pulling on the both ISOFIX connectors.

- 9 After placing the base on the vehicle seat, extend the load leg to floor, When the load leg indicator shows green means it is installed correctly, red means it is installed incorrectly.

When the load leg indicator shows red this means the load leg is in the wrong position.

Make sure the load leg is in full contact with the vehicle floor pan.

Squeeze the load leg releasing button, then shorten the load leg upwards.

The completely assembled base is shown as **10**

This infant carrier is suitable for vehicle seats with i-Size ISOFIX anchor points with the Base.

The ISOFIX connectors must be attached and locked onto the ISOFIX anchor points.

The load leg must be installed correctly with green indicator.

- 11** Push the infant carrier down into the base, if the enhanced child restraint is secure, the enhanced child restraint indicator shows green. **12**

Pull up on the infant carrier to be sure it is securely latched into the base.

- 13** Press the ISOFIX adjustment button and push the base back against the vehicle seat until tight.

- 14** To release the infant carrier, pull the infant carrier up while pull out the stroller fix release button.

- 15** To remove the base, press the secondary lock button first and then the ISOFIX releasing button on the ISOFIX connectors before removing the base from the vehicle seat.

Securing Child in the Enhanced Child Restraint

- 16** While pressing the harness adjustment button, pull completely the two shoulder harnesses of the enhanced child restraint.

- 17** Unlock the buckle of the harnesses by pressing the red button.

- 18** Please do not remove the Head Support before the baby sitting. **19**

- 20** Infant insert is for children's protection. Children whose height is under 60cm are suitable to use the infant insert. **21**

- 22** Check that Shoulder Harness Straps are set at the proper height.

- 23** Place child into the infant carrier-module and lock the buckle. **24**

- 25** Tighten the shoulder harnesses by pulling adjustment webbing.

Installation without base

DO NOT install this infant carrier module on vehicle seats with Lap Belts.

- 26 This infant carrier module is suitable for vehicle seats with a 3-point Retractor Safety Belt only.
- 27 Place the infant carrier module onto the vehicle seat where you wish to put it.
- 28 Pull the vehicle safety belt out and lock it into the vehicle buckle, sliding the vehicle lap belt into the side guides of the infant carrier module.
- 29 Slide diagonal belt into the rear guide.

The infant carrier module can not be used if the vehicle safety belt buckle (female buckle end) is too long to anchor the infant carrier module securely.

- 30 Pull the vehicle shoulder belt to fasten the infant carrier module tightly and securely.

Detaching Seat Pad

see images 31 32

To re-assemble the soft goods, reverse the aforementioned steps.

Care and Maintenance

see images 33 34

Please wash the seat cover and inner padding with cold water under 30°C.

Do not iron the soft goods.

Do not bleach or dry clean the soft goods.

Do not use undiluted detergents , gasoline or other organic solvent to wash the infant carrier module. It may cause damage to the enhanced child restraint.

Do not twist the seat cover and inner padding in an attempt to dry. It may leave the seat cover and inner padding with wrinkles.

Please hang dry the seat cover and inner padding in the shade.

Please remove the enhanced child restraint from the vehicle seat if not in use for a long period of time. Put the enhanced child restraint in a cool, dry place and somewhere your child cannot access it.

- 35 Store instruction manual in the slot with the instruction book icon as shown. Replacement Parts To purchase parts or accessories, please contact us at the following:

www.gracobaby.eu

www.graco.co.uk

www.gracobaby.pl



Product of:

Wonder Brands Limited
Room 1004, 151 Gloucester Road
Wanchai, Hong Kong

CUSTOMER SERVICE :

www.gracobaby.eu • www.graco.co.uk • www.gracobaby.pl

For UK and ROI

Customerservices.uk@gracobaby.eu
+44 0800 952 0063