

AXKID

SPINKID

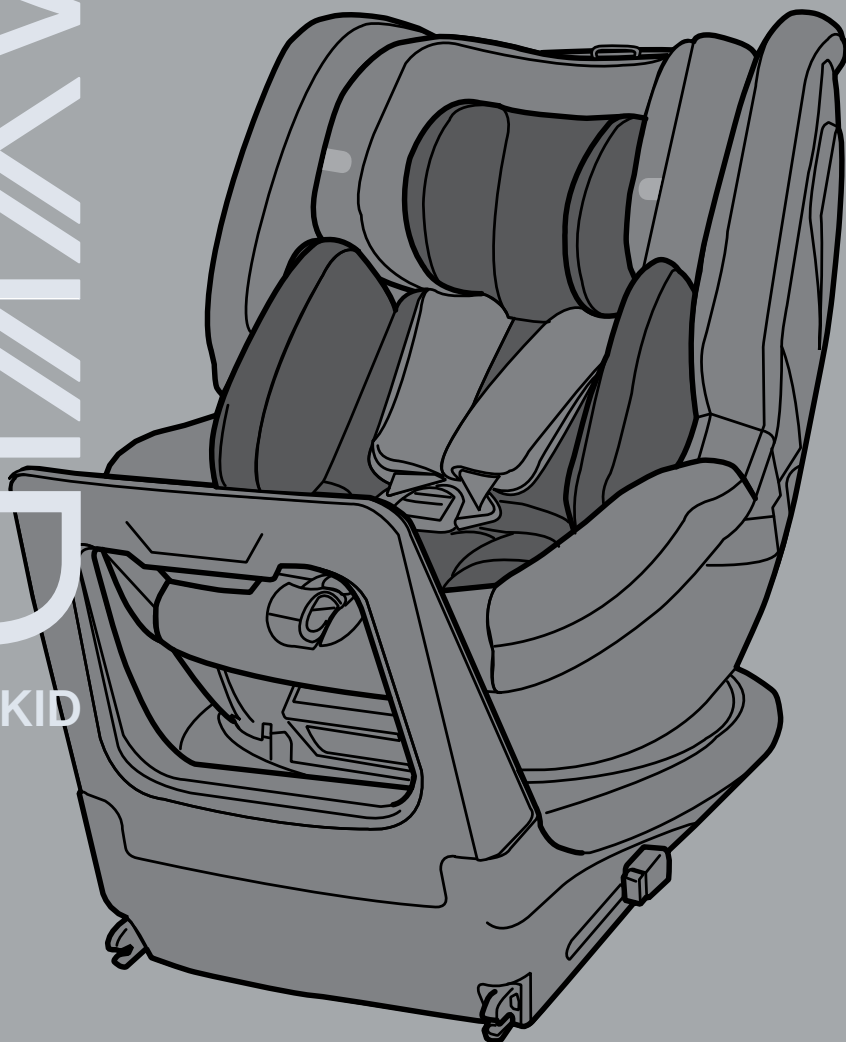

UN regulation no. 129
Instruction Manual
AXKID SPINKID, 40-105 cm

**Designed
in Sweden**



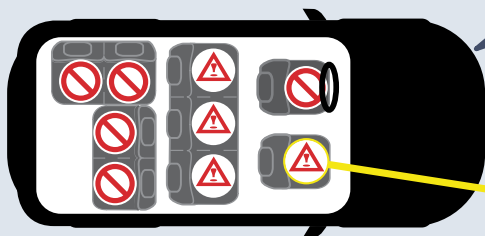
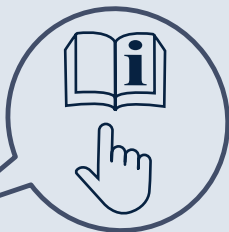

1



2

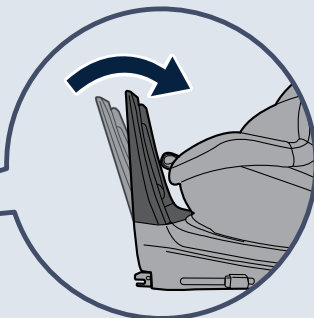
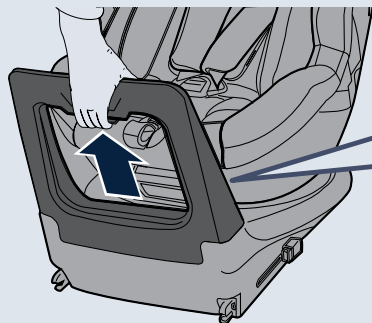

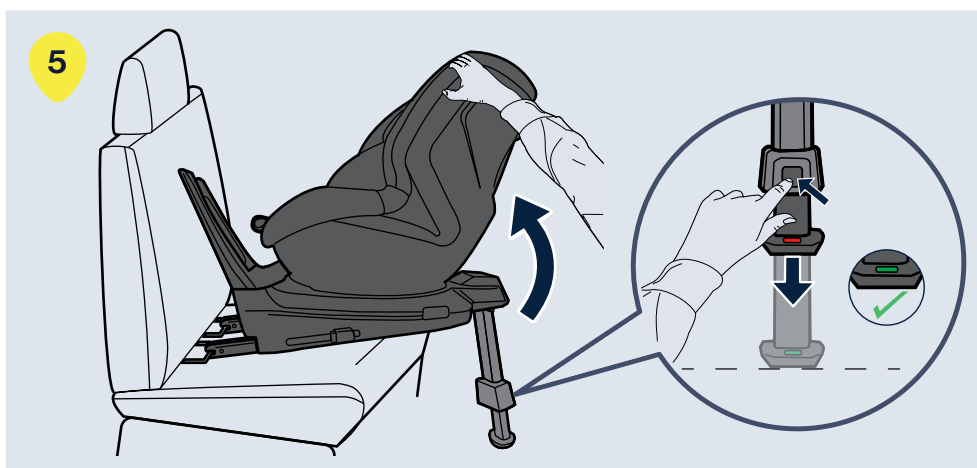
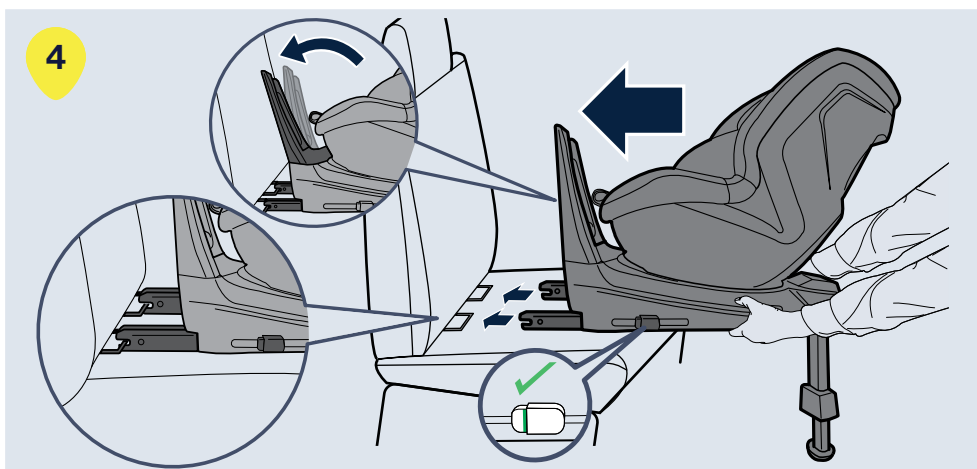
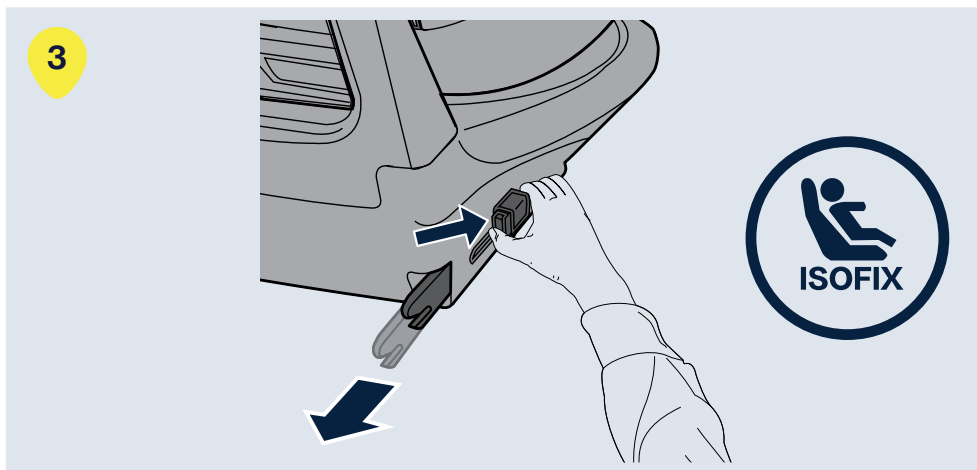

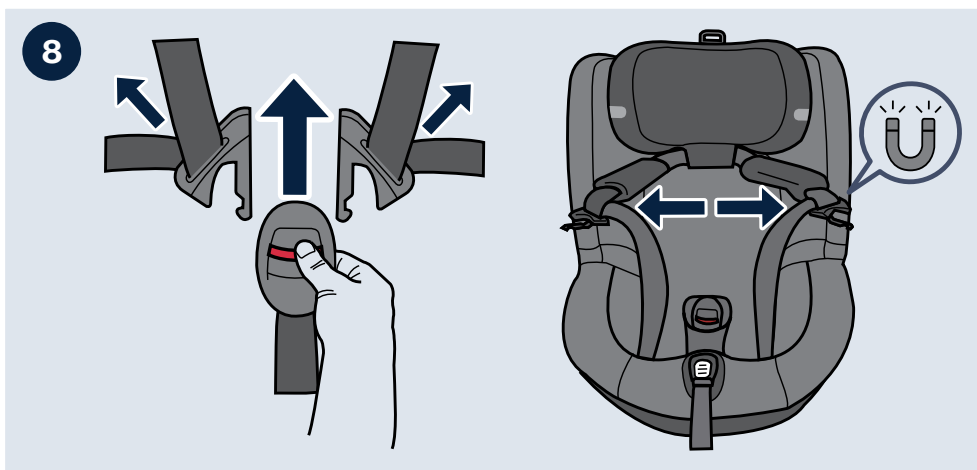
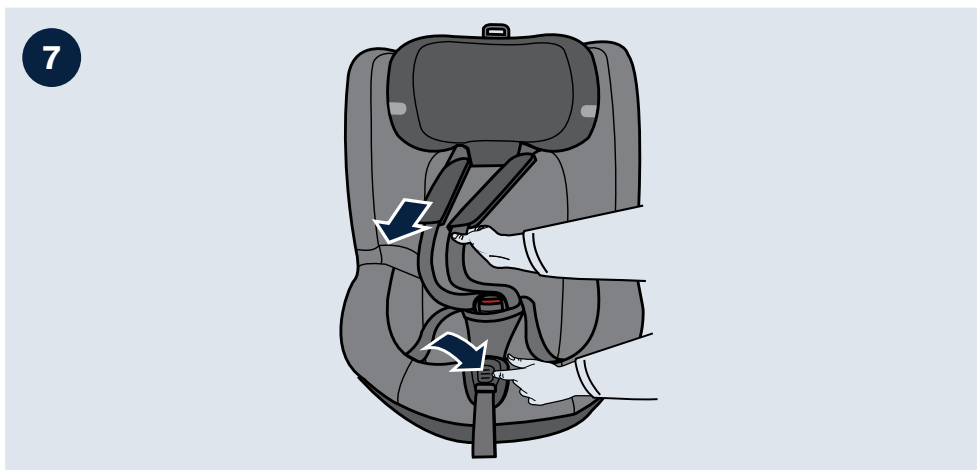
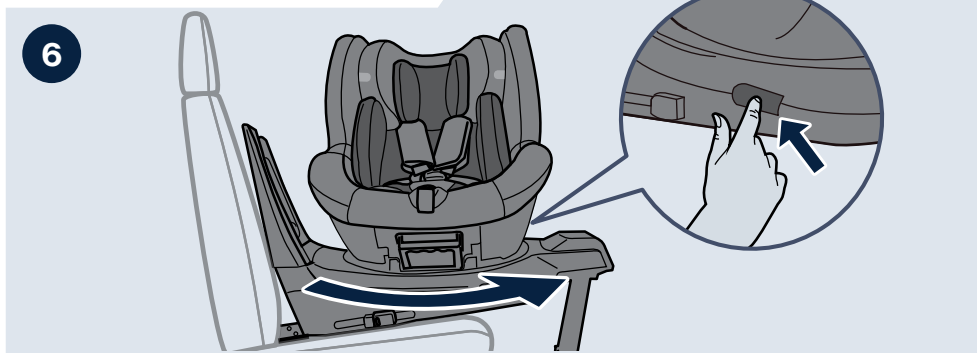

9

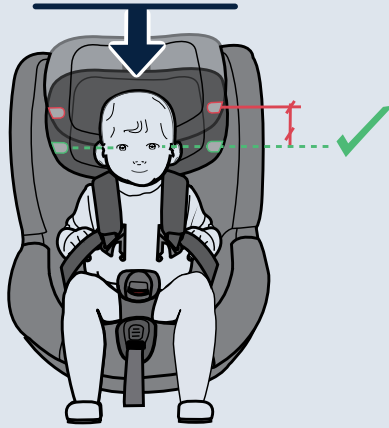

10

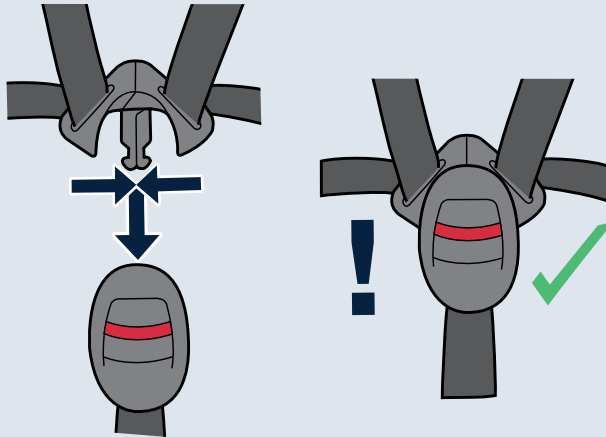

11

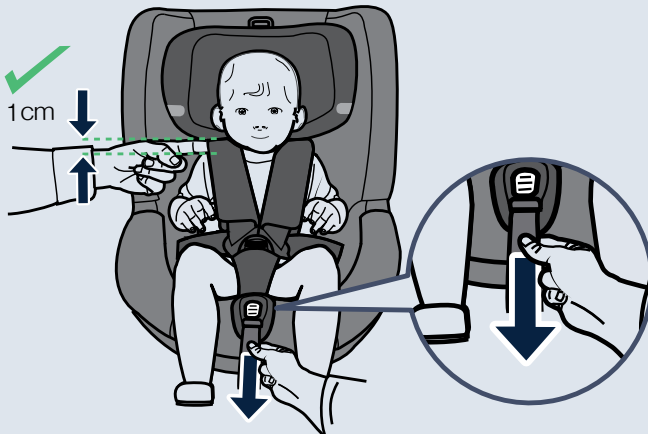



12

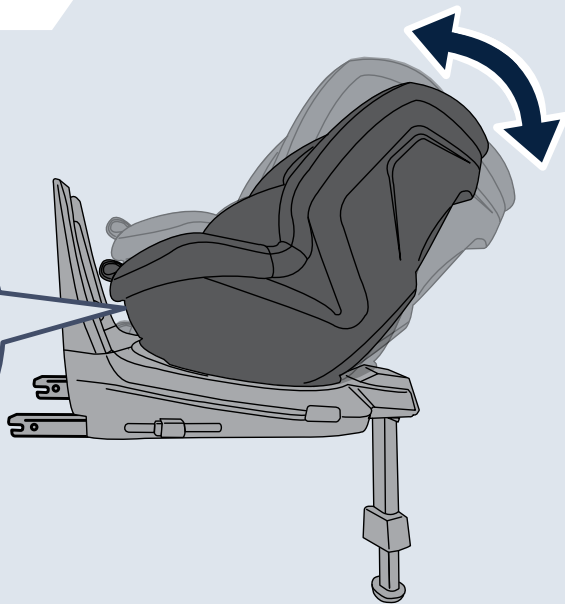
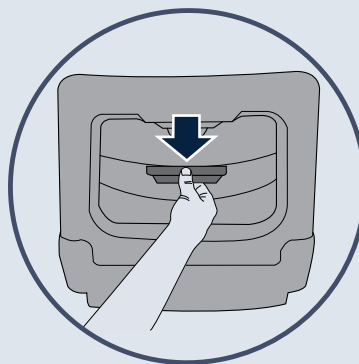



13

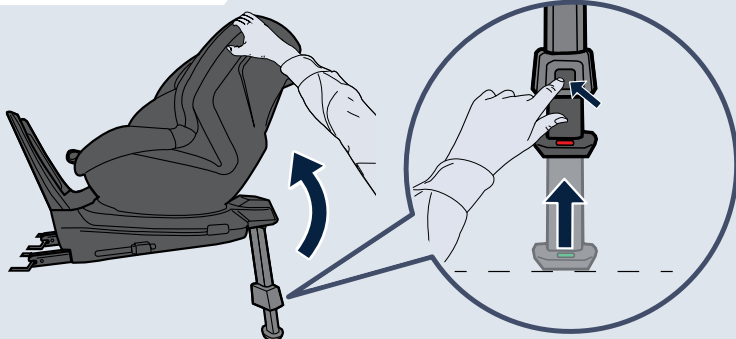

14

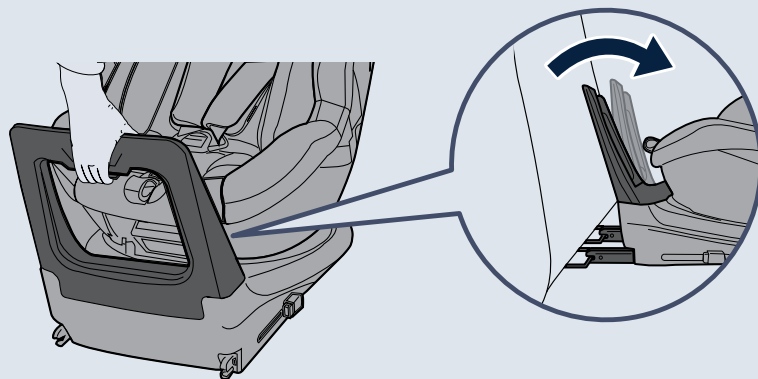

15

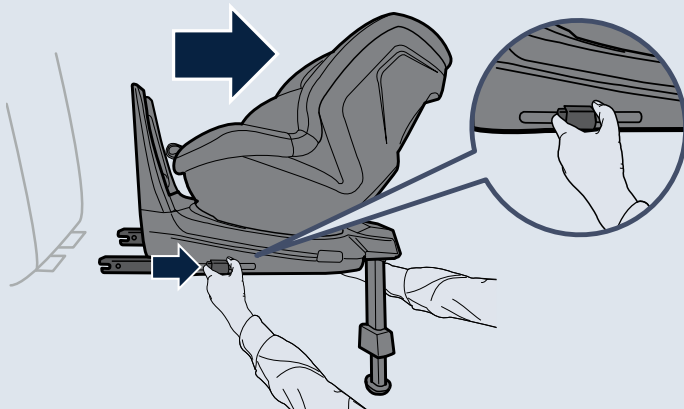

Sverige/Norge

Axkid AB
www.axkid.com
info@axkid.com
Tel: (+46) 511 760 620

UK/Ireland

Axkid Ltd
www.axkid.com
info@axkid.com
Tel: (+44) 0781 086 7644

France

Axkid AB
www.axkid.com
info@axkid.com
Tel (+33) 06 07 01 87 73

Deutschland

Axkid GmbH
www.axkid.com
kundenservice@axkid.com
Tel: +(49) 60-99 84 89 05

Suomi

Lastentarvike
www.lastentarvike.fi
info@lastentarvike.fi
(+358) 09 852 05 100

AXKID

EN	10-19
-----------	-------

DE	XX-XX
-----------	-------

FR	XX-XX
-----------	-------

SV	XX-XX
-----------	-------

NO	XX-XX
-----------	-------

FI	XX-XX
-----------	-------

Thank you for choosing Axxid SPINKID

Read this instruction manual before installing the child seat in your vehicle.
For more information and installation videos visit www.axkid.com.

Axxid SPINKID is a rear-facing car seat approved for children with a height between 40-105 cm, ≤18 kg

This is an i-Size Enhanced Child Restraint System. It is approved according to UN Regulation No. 129, for use in, i-Size compatible vehicle seating positions as indicated by vehicle manufacturers in the vehicle user's manual. If in doubt, consult either the Enhanced Child Restraint System manufacturer (www.axkid.com) or the retailer.

Important information

To maximize your child's safety, it is important that you keep the following in mind:

- Always follow the instructions in this manual. An incorrect installation may seriously affect the safety for your child. If in doubt, contact your retailer who can demonstrate a correct installation.
- Keep this instruction manual for future reference. If manual is lost, you can find it online at www.axkid.com
- Do not use the child seat in a seating position where an active frontal airbag is fitted. If you still wish to install the child seat in this location the airbag must be switched off according to the vehicle manufacturers instructions.
- Should you have an accident, no matter how small, your car seat should always be replaced. It may have damage that is not visible and could seriously affect the safety of your child. For this reason, Axxid does not recommend purchasing secondhand car seats.
- If the child seat has been exposed to direct sunlight, make sure the child seat is not too hot before installing your child.
- Never leave your child unattended in the vehicle.
- Ensure that any luggage or loose objects are secured in your vehicle as they may cause injuries to passengers in the event of an accident.
- Ensure that the child seat is installed in a way where no parts become trapped by movable seats, car doors, etc.
- Do not attempt to disassemble or modify any part of the child seat. The warranty and the safety performance of the Axxid car seat could be affected if doing so.
- Never use the child seat without the textile cover. The seat textile cover is a safety feature and may only be replaced with an Axxid original seat textile cover.
- Read the vehicle handbook and the vehicle list at www.axkid.com to find which seating positions are suitable for this car seat.
- Axxid recommends to always use a seat protection to protect your vehicle seat from scratches and dirt.
- If you have any doubts, contact the retailer where the car seat was purchased or contact info@axkid.com.
- The child seat may only be installed rear-facing.
- Always make sure that the harness is adjusted to correctly fit your child's body. The harness is adjusted by moving the head support.
- Make sure that the child's back is pushed against the car seat when restraining your child with the harness.
- Always make sure that the harness is firmly tightened against your child and that the buckle is completely locked, you should not be able to pinch the straps.
- Make sure there is no twist in the harness.
- Always make sure the support leg is in its correct position and that it has contact with the vehicle floor. The support leg is a very important safety feature designed to maximise your child's safety in an accident.

Table of content

Parts	12
Allowed and disallowed positioning of Axxkid SPINKID car seat	14
Installing Axxkid SPINKID car seat in the vehicle	15
Restraining your child in Axxkid SPINKID car seat	16
Seat adjustments	17
Removing Axxkid SPINKID car seat from the vehicle	17
Care and maintenance	18
Warranty	19

Parts

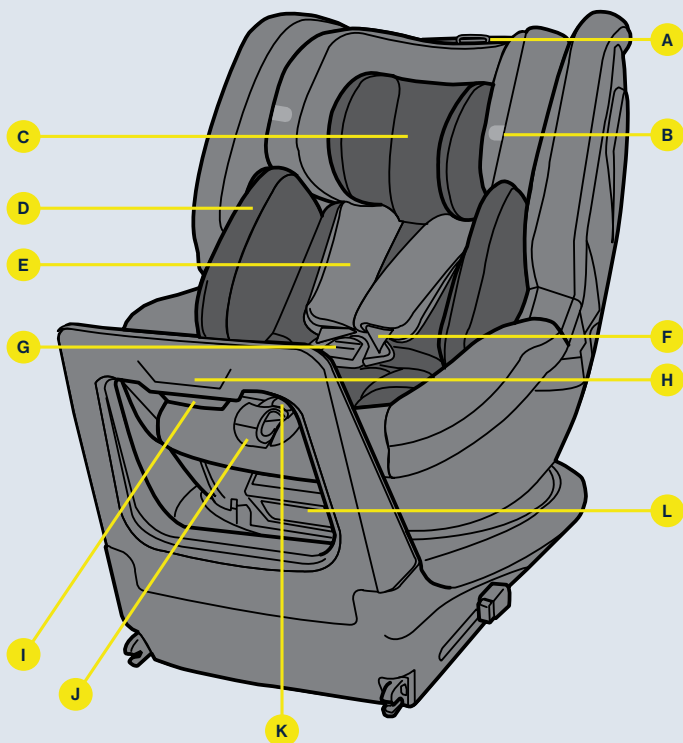

- A HEADREST ADJUSTMENT BUTTON
- B EYE LEVEL INDICATOR
- C HEADREST
- D INFANT INSERT (≤ 75 CM)
- E SHOULDER PADS
- F SHOULDER STRAPS
- G BUCKLE RELEASE BUTTON
- H FRONT BRACE
- I FRONT BRACE RELEASE BUTTON
- J HARNESS TENSION STRAP
- K HARNESS RELEASE BUTTON
- L RECLINE ADJUSTMENT LEVER

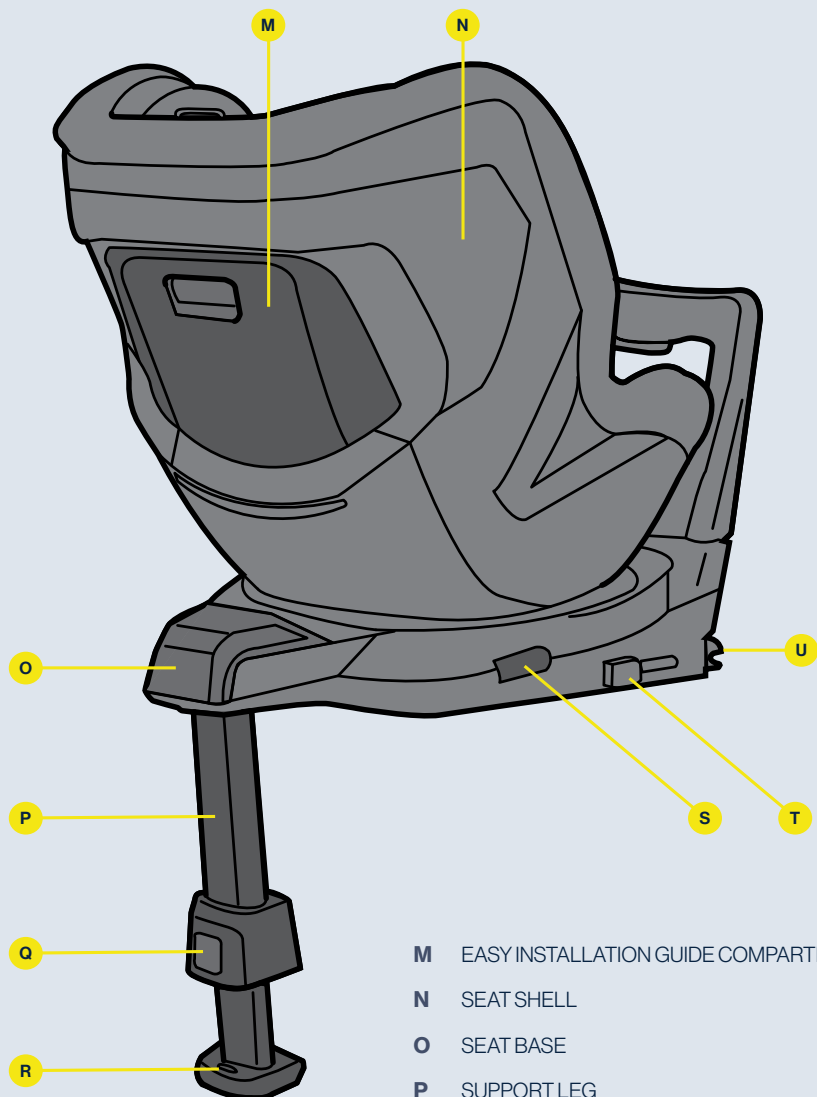

- M** EASY INSTALLATION GUIDE COMPARTMENT
- N** SEAT SHELL
- O** SEAT BASE
- P** SUPPORT LEG
- Q** SUPPORT LEG BUTTON
- R** SUPPORT LEG INDICATOR
- S** ROTATION BUTTON
- T** ISOFIX BUTTON WITH INDICATOR
- U** ISOFIX CONNECTORS



Allowed and disallowed positioning of Axkid SPINKID car seat

Axkid SPINKID car seat can only be installed rear-facing using ISOFIX. It is approved for use in all i-Size approved seating positions but may also fit in other non i-Size-approved ISOFIX seating positions. Check your vehicle instruction manual to find suitable seating positions and check the vehicle list on www.axkid.com

Front passenger seat with ISOFIX (no active airbag)	YES/NO*
Front passenger seat with ISOFIX (active airbag)	NO
Rear passenger seat with ISOFIX	YES
Side and rear facing seats with ISOFIX	NO
Seats without ISOFIX	NO

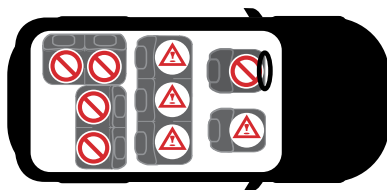

IMPORTANT: If you wish to install your Axkid SPINKID car seat in a location where a frontal airbag is fitted, the airbag must be disconnected according to your vehicle manufacturer instruction. Note that some vehicles require an authorized service centre to disconnect the airbag.

* The General Regulation of Traffic in Spain, in its article 117, establishes the prohibition of driving with children of stature equal to or less than 135 centimetres located in the front seats of the vehicle, without exceptions.



Never install a child restraint in a passenger seat where an active airbag is fitted.





Installing Axxkid SPINKID car seat in the vehicle

1

Fold down the support leg (P).

2

Release the front brace (H) with the release button (I) and fold the front brace towards the seat.

3

Push the ISOFIX buttons (T) and extend the ISOFIX connectors (U) into their outmost positions.

4

Grab the front brace (H) and the seat base (O) with the other hand and lift the Axxkid SPINKID car seat into your vehicle. Push the ISOFIX connectors (U) into the ISOFIX connection points in the vehicle until you hear a click and the ISOFIX button indicators (T) turn green. Release the front brace (H) with the release button (I) and fold the front brace towards the vehicle seat. Push the car seat as far as possible towards the vehicle seat. The front brace (H) should be firmly pressed against the vehicle seat.

5

Lift the car seat upwards and push the support leg button (Q). Pull the support leg (P) downwards until it is in contact with the vehicle floor. Let go of the support leg button (Q) and further extend the support leg (R) until you hear a click. The support leg (P) should now be locked and firmly pressed against the vehicle floor.

Note: The support leg is equipped with a visual indicator (R) that will turn green when the support leg is firmly pressed against the floor, indicating a correct installation.



Restraining your child in Axkid SPINKID car seat

Before restraining your child in the Axkid SPINKID car seat, make sure you have the correct insert installed in the seat. Axkid SPINKID is designed to grow with your child and to ensure a comfortable and safe fit for the child. Axkid recommends using the insert until it is too tight for your child, but to a minimum length according to table below (note that the age is just an indication):

Age	Height	
Infant 0-1 years	40 – 75 cm	
Toddler 1-3 years	76 – 105 cm	No insert

- 6

Push the rotation button (S).
- 7

Rotate the child seat until it locks into its outmost position.
- 8

Loosen the harness by pressing the harness release button (K) and pull out both shoulder straps (F) at the same time.

Note: Avoid pulling only one strap at the time since it may cause the shoulder straps to become uneven.
- 9

Unlock the buckle by pressing the buckle release button (G) and attach the buckle connectors on top of the magnets located on the seat rim.
- 10

Pull the headrest adjustment button (A) and slide the headrest upwards or downwards until the eye level indicators (B) are in line with your child's eyes.

Note: the eye level indicators (B) shall not be used when using the infant insert. Always make sure that the headrest is in the lowest position when using SPINKID for infants.
- 11

Place your child in the seat and place the shoulder straps (F) over your child's shoulder. Lock the harness by first positioning the parts of the buckle that is attached to the shoulder straps (F) together and then push them into the buckle until you hear a click.
- 12

Check that the shoulder straps (F) are going through the seat straight from your child's shoulders or maximum 1 cm above. You might need to adjust the headrest (C) again, even if it makes the eye level indicator get out of line with your child's eyes. Now pull on the shoulder straps (F) to tighten the harness over your child's hips. While keeping tension in the shoulder straps (F), pull the harness tension strap (J) until the harness is tightened enough. You should not be able to fit more than one finger between the shoulder straps (F) and your child's shoulders.



Seat adjustment

After the Axkid SPINKID car seat has been installed in your vehicle you can easily adjust the recline position for your child. This can also be done while your child is restrained in the car seat.

Pull the recline adjustment lever (L) to adjust the seat into one of the four fixed positions.



Removing Axkid SPINKID car seat from your vehicle

- Lift the car seat upwards and push the support leg button (Q). Collapse the support leg (P) to its shortest position.
- Push the front brace release button (I) and fold the front brace (H) towards the seat to release the tension against the vehicle seat.
- Disconnect the ISOFIX connectors (U) by pushing down on the ISOFIX buttons (T) and then slide them backwards, away from the vehicle seat.
- Grab the front brace (H) and the seat base (O) with the other hand and lift the Axkid SPINKID car seat out of your vehicle.
- Push the ISOFIX buttons (T) and retract the ISOFIX connectors (U) into their innermost positions.

Care and maintenance

The seat textile cover can be machine washed at 30° C on a gentle cycle. Do not put the cover in a dryer as this can damage the cover and the padding may separate from the fabric. Visit www.axkid.com to find videos explaining how to remove and attach the cover.

Remove the textile cover:

- Loosen the harness by pressing the harness release button (K) and pull out both shoulder straps (F) at the same time.
- Carefully pull the cover off from the headrest (C).
- Lower the headrest (C) to the lowest position.
- Unlock the harness buckle by pressing the buckle release button (G) and remove the buckle cover.
- Undo the four buttons at the backrest on the inside of the car seat and gently remove the textile cover from the car seat. Be careful around plastic covers not to damage the textile. Don't pull too hard.
- Open the shoulder pads (E) and gently remove them from the Velcro.

Install the textile cover

- Reverse the steps from the instruction above to install the textile cover on the car seat again.
- Note that the shoulder pads can be installed at different positions. Install them in a position suitable for your child, the shoulder pads should be positioned on top of the shoulder and on the chest of your child. Also make sure that the rubber side of the shoulder pad is facing your child's chest.

If the textile seat cover needs replacing, ensure only original products from Axkid are used. If other products are used, the Axkid car seat's safety system may be compromised and could lead to severe injury in case of an accident.

Any plastic parts of the Axkid car seat can be cleaned with mild detergent and water. Do not use aggressive chemicals containing solvents or similar, as this can cause damage to the plastic and compromise the safety of the car seat.

Recycling your car seat



Axkid strongly recommends recycling of old car seats. Before leaving the seat at your local recycling station cut off the harness straps from the seat, remove the textile cover, remove as many Styrofoam parts as possible, separate metal and plastic parts if possible. The main part of the seat should be marked unsafe or expired (use a marker) to deter anyone from using it again. Please check your local municipal guidelines for recycling instructions for the different materials.

Warranty

The Axkid car seat is covered by a 24-month warranty from date of purchase. Ensure you save your receipt and bring it to your place of purchase if you have any warranty issues the warranty does not cover.

- Normal wear and tear.
- Damage due to incorrect use, neglect, or accident.
- If repairs have been carried out by a third party.
- All materials used have a very high UV-resistance rating. However, UV-light is very aggressive and will ultimately lead to fading of the seat cover. This is not covered by our warranty as it is considered normal wear and tear.
- Handle the seat with care. Never carry the seat by holding in the headrest.

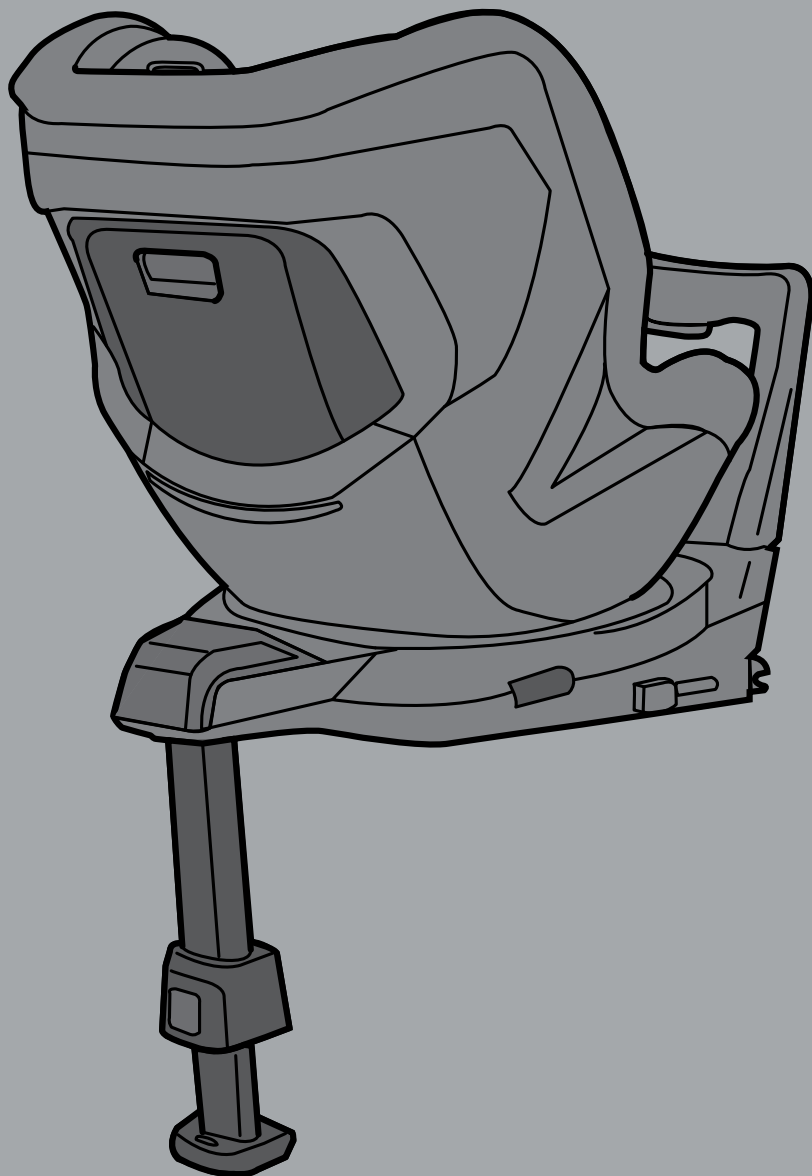

- EN
- DE
- FR
- SV
- NO
- FI

AXKID

© Copyright Axkid 2023
All rights reserved Axkid AB | Göteborgsvägen 94 | 43137 Mölndal | Sweden

MAR 2023 Art.no 1104966